

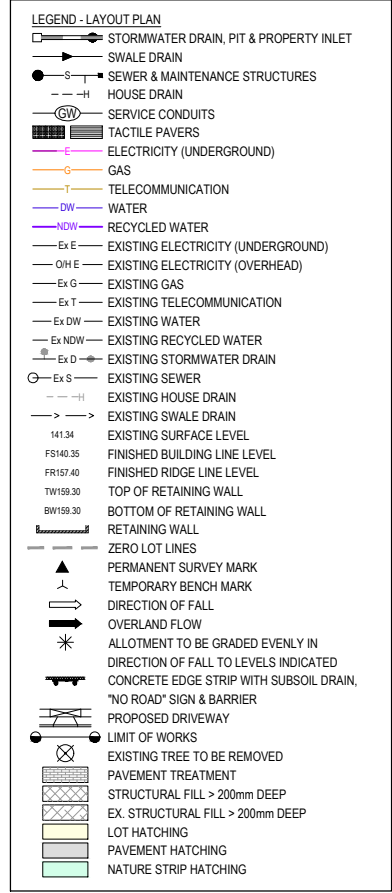

125 HARDYS ROAD DANIEL ROBERTSON PTY LTD FUTURE TOWN CENTRE



- NOTE:**
- These plans are preliminary only and have not been approved by Council. They are subject to change without notification and have been provided as a guide only.
  - Beveridge Williams & Co Pty Ltd will not be liable for any loss or damages incurred or suffered by any party due to the use of the plans or relying on the information contained within these plans.
  - No fill depths have been shown. All levels shown on the plans are preliminary only and subject to change without notice.
  - All levels shown are preliminary and subject to detailed design.
  - Existing services under new pavements, paths and driveways to be FCR backfilled.
  - Existing pits and MH within new works to be adjusted to neatly match new finished surface.
  - Proposed services shown are preliminary only and subject to authority advice and approval.

FOR CONTINUATION REFER DRAWING No.1801767-20-M02

SERVICE OFFSET TABLE

Location	Gas		ND - Water		Water		Electricity		Telecommunication		Sewer		Lighting	
	Side	Offset (m)	Side	Offset (m)	Side	Offset (m)	Side	Offset (m)	Side	Offset (m)	Side	Offset (m)	Side	Offset (m)
ARAVALLI CRESCENT (NORTH - SOUTH)	E	2.10	E	2.50	E	2.95	W	1.10	W	0.40	E	1.00	BOK	0.8
ARAVALLI CRESCENT (EAST - WEST)	N	2.10	N	2.50	N	2.95	S	2.50	S	1.90	N/S	1.00/1.00	BOK	0.8
HEARTHSTONE CIRCUIT	W	2.10	W	2.50	W	2.95	E	2.60	E	1.90	W	1.00	BOK	0.8
EIGER STREET	N	2.10	N	2.50	N	2.95	S	2.60	S	1.90	N	1.00	BOK	0.8
STONEFOX CIRCUIT (NORTH - SOUTH)	W	1.85	W	2.25	W	2.70	E	1.10	E	0.40	-	-	BOK	0.8
STONEFOX CIRCUIT (EAST - WEST)	N	2.10	N	2.50	N	2.95	S	1.10	S	0.40	-	-	BOK	0.8
PORTOBELLO BOULEVARD	N	2.10	N	2.55	N	3.05	S	2.60	S	1.90	N	1.00	BOK	0.8

NOTE: STREET TREES ARE TO BE PLANTED IN THE CENTRE OF ALL NATURE STRIPS

ROAD LAYOUT TABLE

Road Name	Reserve Width (m)	Road Width (m)			Kerb Type		Verge Width (m)	
		Lip to Lip	Inv to Inv	Back to Back	Nth/West	Sth/East	Nth/West	Sth/East
ARAVALLI CRESCENT (NORTH - SOUTH)	14.50	6.40	7.30	7.60	600 B2	600 B2	4.50	2.70
ARAVALLI CRESCENT (EAST - WEST)	16.00	6.40	7.30	7.60	600 B2	600 B2	4.50	4.20
HEARTHSTONE CIRCUIT	16.00	6.40	7.30	7.60	600 B2	600 B2	4.50	4.20
EIGER STREET	16.00	6.40	7.30	7.60	600 B2	600 B2	4.50	4.20
STONEFOX CIRCUIT (NORTH - SOUTH)	14.50	6.40	7.30	7.60	600 B2	600 B2	4.50	2.70
STONEFOX CIRCUIT (EAST - WEST)	14.50	6.40	7.30	7.60	600 B2	600 B2	4.50	2.70
PORTOBELLO BOULEVARD	30.00	15.60	16.50	16.80	600 B2	600 B2	6.65	6.85

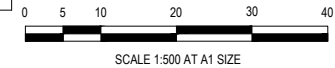

**WARNING**  
**BEWARE OF UNDERGROUND SERVICES**  
 The locations of underground services are approximate only and their exact position should be proven on site.  
 No guarantee is given that all existing services are shown. Locate all underground services before commencement of works.  
**DIAL 1100 BEFORE YOU DIG**  
 www.1100.com.au

**PRELIMINARY PRINT**  
**NOT FOR CONSTRUCTION**

REV	DESCRIPTION	DATE	DRN.	APP.	REV	DESCRIPTION	DATE	DRN.	APP.
P5	ELECTRICAL KIOSK UPDATED AND GENERAL AMENDMENTS	03.03.20	M.F.	M.F.					
P4	STAGE 20A SUPERLOT LEVELS UPDATED	28.01.20	M.F.	A.D.					
P3	LOT LEVELS UPDATED	06.12.19	M.F.	A.D.					
P2	LOTS 2008 & 2029 UPDATED	28.11.19	M.F.	M.F.					
P1	ISSUED FOR INFORMATION	27.11.19	M.F.	M.F.	P6	LOT 2031 DRIVEWAY RELOCATION	22.07.20	J.T.	M.F.



Designed by M. FELICIANO  
 Date 27.11.19  
 Drawn by M.F. JAURIGUE  
 Approved by A.DAVIS  
 Date 27.11.19  
 PS Number PS837134L



Project Details  
 MERIDIAN CENTRAL ESTATE  
 STAGE 20  
 CITY OF CASEY  
 Drawing Title  
 MARKETING PLAN  
 (SHEET 1 OF 2)

Sheet 01 of 02  
 Scale 1:500 @ A1  
 Project Ref 1801767  
 Stage No 20  
 Drawing No M01  
 Rev P6



125 HARDYS ROAD DANIEL ROBERTSON PTY LTD FUTURE TOWN CENTRE

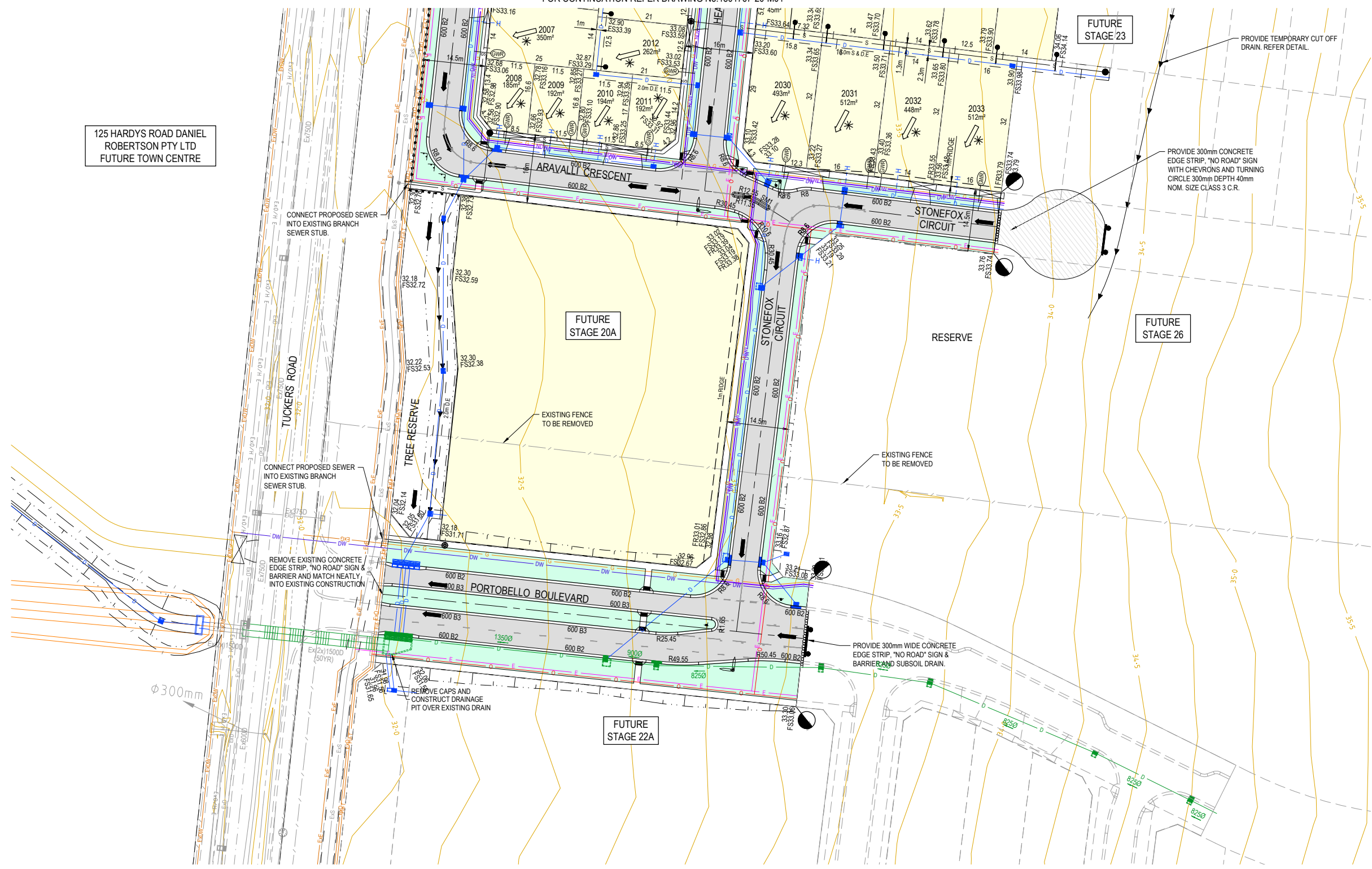

**LEGEND - LAYOUT PLAN**

- SWORMWATER DRAIN, PIT & PROPERTY INLET
- SWALE DRAIN
- SEWER & MAINTENANCE STRUCTURES
- HOUSE DRAIN
- SERVICE CONDUITS
- TACTILE PAVERS
- ELECTRICITY (UNDERGROUND)
- GAS
- TELECOMMUNICATION
- WATER
- RECYCLED WATER
- EXISTING ELECTRICITY (UNDERGROUND)
- EXISTING ELECTRICITY (OVERHEAD)
- EXISTING GAS
- EXISTING TELECOMMUNICATION
- EXISTING WATER
- EXISTING RECYCLED WATER
- EXISTING STORMWATER DRAIN
- EXISTING SEWER
- EXISTING HOUSE DRAIN
- EXISTING SWALE DRAIN
- EXISTING SURFACE LEVEL
- FINISHED BUILDING LINE LEVEL
- FINISHED RIDGE LINE LEVEL
- TOP OF RETAINING WALL
- BOTTOM OF RETAINING WALL
- RETAINING WALL
- ZERO LOT LINES
- PERMANENT SURVEY MARK
- TEMPORARY BENCH MARK
- DIRECTION OF FALL
- OVERLAND FLOW
- ALLOTMENT TO BE GRADED EVENLY IN DIRECTION OF FALL TO LEVELS INDICATED
- CONCRETE EDGE STRIP WITH SUBSOIL DRAIN, "NO ROAD" SIGN & BARRIER
- PROPOSED DRIVEWAY
- LIMIT OF WORKS
- EXISTING TREE TO BE REMOVED
- PAVEMENT TREATMENT
- STRUCTURAL FILL > 200mm DEEP
- EX. STRUCTURAL FILL > 200mm DEEP
- LOT HATCHING
- PAVEMENT HATCHING
- NATURE STRIP HATCHING

- NOTE:**
1. These plans are preliminary only and have not been approved by Council. They are subject to change without notification and have been provided as a guide only.
  2. Beveridge Williams & Co Pty Ltd will not be liable for any loss or damages incurred or suffered by any party due to the use of the plans or relying on the information contained within these plans.
  3. No fill depths have been shown. All levels shown on the plans are preliminary only and subject to change without notice.
  4. All levels shown are preliminary and subject to detailed design.
  5. Existing services under new pavements, paths and driveways to be FCR backfilled.
  6. Existing pits and MH within new works to be adjusted to neatly match new finished surface.
  7. Proposed services shown are preliminary only and subject to authority advice and approval.

**WARNING**  
**BWARE OF UNDERGROUND SERVICES**  
 The locations of underground services are approximate only and their exact position should be proven on site.  
 No guarantee is given that all existing services are shown. Locate all underground services before commencement of works.  
**DIAL 1100 BEFORE YOU DIG**  
 www.1100.com.au

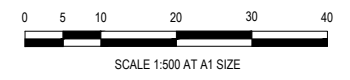

**PRELIMINARY PRINT**  
**NOT FOR CONSTRUCTION**

© COPYRIGHT All rights reserved Beveridge Williams & Co. Pty Ltd has granted a licence to the principle to use this document for its intended purpose. No unauthorised copying is permitted.					
P5	ELECTRICAL KIOSK UPDATED AND GENERAL AMENDMENTS	03.03.20	M.F.	M.F.	
P4	STAGE 20A SUPERLOT LEVELS UPDATED	28.01.20	M.F.	A.D.	
P3	LOT LEVELS UPDATED	06.12.19	M.Z.	A.D.	
P2	LOTS 2008 & 2029 UPDATED	28.11.19	M.F.J.	M.F.	
P1	ISSUED FOR INFORMATION	27.11.19	M.F.J.	M.F.	
REV	DESCRIPTION	DATE	DRN.	APP.	REV
P6	LOT 2031 DRIVEWAY RELOCATION	22.07.20	J.T.	M.F.	



Designed M. FELICIANO  
 Date 27.11.19  
 Drawn M.F. JAURIGUE  
 Approved A. DAVIS  
 Date 27.11.19  
 PS Number PS837134L



Project MERIDIAN CENTRAL ESTATE  
 Details STAGE 20  
 CITY OF CASEY  
 Drawing MARKETING PLAN  
 Title (SHEET 2 OF 2)

Sheet 02 of 02

Scale 1:500 @ A1

Project Ref 1801767 Stage No 20 Drawing No M02 Rev P6

