

MERIDIAN CENTRAL ESTATE - STAGE 35

BROWN PROPERTY GROUP

CITY OF CASEY

CONSTRUCTION NOTES

SITE MANAGEMENT

- A1. Prior to commencement of works on site, the contractor must ensure that all matters relating to the Occupational Health & Safety Act 2004, including all relevant regulations, have been addressed. In particular, the required notifications must be conveyed to the Victorian Workcover Authority - Health & Safety division with respect to trenching operations. Details of the contractors occupational health & safety procedures must be lodged with the superintendent prior to commencement of works.
- A2. All native trees & shrubs to be retained unless road construction necessitates their removal or removal is directed by the engineer. A town planning permit is required for the removal of native trees & / or vegetation. The removal or retention of any existing trees must be in accordance with the approved landscape plan, or else approval will be required from the City of Casey landscape approvals officer.
- A3. Existing dam or watercourses to be excavated to a firm base & backfilled as specified. Consulting engineer to be notified when the dam or watercourses are excavated to a firm base. No filling is to be placed prior to dams being inspected & levels taken. Backfilling is to be carried out to the satisfaction of the Council supervising engineer.
- A4. Prior to commencement of works, the contractor must submit a Site Management Plan (SMP) to the consultant for approval. The contractor must comply with the recommendations of the Environment Protection Authority publication No.275 "Construction techniques for sediment pollution control". Appropriate siltation control is to be maintained throughout the construction & maintenance period of the works.
- A5. Provide temporary safety barrier fence (Farm Fence as per MW Std Dwg 725/14/203) along extent of outfall drain where the drain is greater than 1.5m in depth & side slopes are steeper than 1 in 3. Safety fence to remain until permanent underground drainage is installed.
- A6. Contractor to remove existing irrigation & drainage pipes & pits encountered on site. Trenches to be backfilled in accordance with notes C2 & C3.
- A7. An environmental management plan (EMP) must be submitted to and approved by Council prior to the commencement of any works on site and all works must be carried out in accordance with this EMP.
- A8. A traffic management plan (TMP) must be submitted to, and approved by Council prior to the commencement of any works on site and all traffic management must be carried out in accordance with this TMP.

GENERAL

- B1. All works to be carried out in accordance with AS2124-1992 general conditions of contract & the City of Casey and EDCM current specification & standard drawings & to the satisfaction of the City of Casey works supervisor.
- B2. Council to be notified two (2) clear days prior to commencement of works.
- B3. Before commencement of works on trenches in excess of 1.5m deep, the civil contractors construction supervisor must give notice in writing of such proposals to Worksafe Victoria in accordance with Part 5.1, Division 4 of the Occupational Health & Safety regulations (2007) & undertake safety precautions in trenching operations in accordance with Workcover's code of practice (1988).
- B4. Lots to be graded (1 in 150 min slope) & left clean to the satisfaction of the engineer. Finished levels to be compatible with lots adjoining this stage.
- B5. On completion the contractor is responsible for the removal of all rubbish & spoil from site. No surplus trees, vegetation or other material is to be burnt on site.
- B6. Reserves to be free draining & to be left in a condition satisfactory to the City of Casey works supervisor.
- B7. Where works are in the vicinity of existing services these services are to be located & the various authorities notified prior to the commencement of works.
- B8. All TBM's & control points are to be maintained & protected at all times during construction. Should any marks be disturbed, the contractor will immediately notify the consultant to arrange re-instatement at the contractors expense.
- B9. Provide painted paling fence along any boundary common to lots & municipal reserves as per Council Std. Dwg. S-706. Paling to be on the reserve side.
- B10. As constructed plans and electronic asset information in D-Spec and R-Spec format must be submitted to Council prior to practical completion.
- B11. Temporary crushed rock turn around areas must be maintained in a safe and sound condition so that vehicles are able to use them at all times.

ROADWORKS

- C1. 100e agricultural pipe drains (MPA standard drawing EDCM 202) to be placed behind all kerb & channel & buffer plichs & where directed by the engineer.
- C2. Filling in all properties & road reserves is to be carried out using approved clay fill. Top soil & all vegetable matter to be stripped from site prior to filling. All filling to be carried out in accordance with AS3798-2007 and the geotechnical report. Level 1 inspection and testing to be carried out in accordance with AS3798-2007 Section 8.2. A fill report must be submitted to the Consultant, showing from a NATA registered soil testing laboratory.
- C3. Importing Fill:- All imported fill must be tested by a NATA approved laboratory to ensure it is suitable for use on site, & any contaminants are within accepted levels. Under no circumstances should fill material enter or leave the site without the permission of the supervising engineer & Council works supervisor, prior to it being appropriately tested. All vehicles transporting fill material to & from the site must have appropriate measures in place to ensure that material does not get onto roads & into stormwater systems & natural waterways.
- C4. Batters to be 1 in 5 for fill & 1 in 3 for cut unless noted otherwise.

- C5. Cut batters are to be grassed & mulched with a mixture of chopped grass, straw & bitumen emulsion.
- C6. Where cut batters exceed 700mm an additional 300mm berm shall be formed behind footpath.
- C7. Access ramps are to be constructed where cut batters exceed 1.0m. They are to be graded 1 in 10 for the first 2.5m from the back of path & then at a maximum of 1 in 4 to natural surface.
- C8. The water conduit offset from the lot boundary is given on the water reticulation plan. The contractor must construct conduits to accord with the given offset & ensure that the concreter marks the kerb & footpath exactly above the conduit.
- C9. Irrigation conduits are to be DN100 DWW PVC installed beneath the pavement and/or capping layer, if present. Locations are to be marked using a green dot spray painted on the top of kerb.
- C10. All footpaths are to be 125mm thick 25MPa concrete with SL72 mesh centrally located in accordance with the MPA standard drawing EDCM 401.
- C11. NBN Co to be notified seven (7) days prior to concrete works being placed.
- C12. Electrical distribution pits within footpaths are to be a minimum of 300mm within the edge of the path. Concrete is to be placed around distribution pits to a minimum depth of 200mm.
- C13. All street signs to be constructed & erected to current City of Casey standards including logo. Court street names are to show court name only.
- C14. Traffic control signs, markings & delineators to be installed in accordance with AS1742.2. All line marking is to be long life road marking, with longitudinal lines in thermoplastic & transverse markings in cold applied.
- C15. Driveways to be constructed in accordance with the MPA standard drawings EDCM 501 & EDCM 502. Single driveways to be a minimum 3.5m wide & to be offset 0.75m from side boundary or easement unless otherwise shown.
- C16. Kerb transition to take place in the minor street over a 2.0m length from either the tangent point or TP pit.
- C17. Existing road works to be reconstructed as required to provide, without discontinuity, a connection in accordance with design levels & grades.
- C18. Provide 2.5m wide shared footpath through reserves as shown on a curvilinear alignment to the satisfaction of the engineer.
- C19. Tactile ground surface indicators (TGSi) are to be installed at all pram crossings & pedestrian cross points in accordance with AS1428.4 : 2002 & MPA standard drawing EDCM 403.
- C20. If any existing substandard filling is encountered on the site it must be removed and replaced with approved fill material properly compacted to Council requirements. A geo-technical report must be submitted showing details of depth, type of material and density of the fill areas concerned.

DRAINAGE

- D1. Drainage & pits to be set out from offsets shown rather than from centreline pipe chainages. Centreline of pits at TP's to be offset 1.00m.
- D2. Terra Firma or fibreglass type pit lids are required for all drainage pits & all grates for pits are to be Class D, to comply with AS3996 unless otherwise shown. All drainage works are to be constructed to council specifications.
- D3. All pipes up to and including 750mm in diameter shall be rubber ring jointed (RRJ). Pipes above this size may be flush jointed with external sealing bands. For pipes greater than 900mm and changes in direction between 2 connecting pipes exceeding 10° construct segmented curves using splayed pipes with bandage joints, having deflections within the manufacturer's specification.
- D4. All pipes to be Class 'Z' R.C. rubber ring joint unless noted otherwise. PVC pipes to be Class SH unless specified.
- D5. Pipe trenches beneath the road pavement, footpath or within 150mm of the kerb & channel to be backfilled with 20mm Class 3 FCR in 150mm layers.
- D6. Property inlets to be constructed as per MPA standard drawing EDCM 701 - EDCM 704.
- D7. All proposed drainage stubs to be blanked off at end of pipe with timber planks to the satisfaction of the supervising engineer.
- D8. A CCTV report must be provided for all drainage lines prior to issue of practical completion.

PAVEMENT

- E1. Modification of the pavement requires approval by the City of Casey works supervisor.

DRAWING INDEX

DRAWING No.	TITLE	REVISION
1801767-35-001	COVER SHEET	A
1801767-35-002	TYPICAL ROAD CROSS SECTIONS AND GENERAL DETAILS	A
1801767-35-003	RETAINING WALL DETAILS AND PAVEMENT MAKEUP	A
1801767-35-010	LAYOUT PLAN	A
1801767-35-100	ROAD LONGITUDINAL SECTIONS RATHI STREET AND KENANA STREET	A
1801767-35-101	ROAD LONGITUDINAL SECTIONS CARORA CIRCUIT (SHEET 1 OF 2)	A
1801767-35-102	ROAD LONGITUDINAL SECTIONS CARORA CIRCUIT (SHEET 2 OF 2) & RESERVE FOOTPATH	A
1801767-35-200	ROAD CROSS SECTIONS RATHI STREET & RESERVE FOOTPATH	A
1801767-35-201	ROAD CROSS SECTIONS KENANA STREET	A
1801767-35-202	ROAD CROSS SECTIONS CARORA CIRCUIT (SHEET 1 OF 2)	A
1801767-35-203	ROAD CROSS SECTIONS CARORA CIRCUIT (SHEET 2 OF 2)	A
1801767-35-300	INTERSECTION DETAILS (SHEET 1 OF 2)	A
1801767-35-301	INTERSECTION DETAILS (SHEET 2 OF 2)	A
1801767-35-350	SIGNAGE & LINE MARKING PLANS	A
1801767-35-400	DRAINAGE LONGITUDINAL SECTIONS (SHEET 1 OF 2)	A
1801767-35-401	DRAINAGE LONGITUDINAL SECTIONS (SHEET 2 OF 2)	A
1801767-35-402	PIT SCHEDULE	A

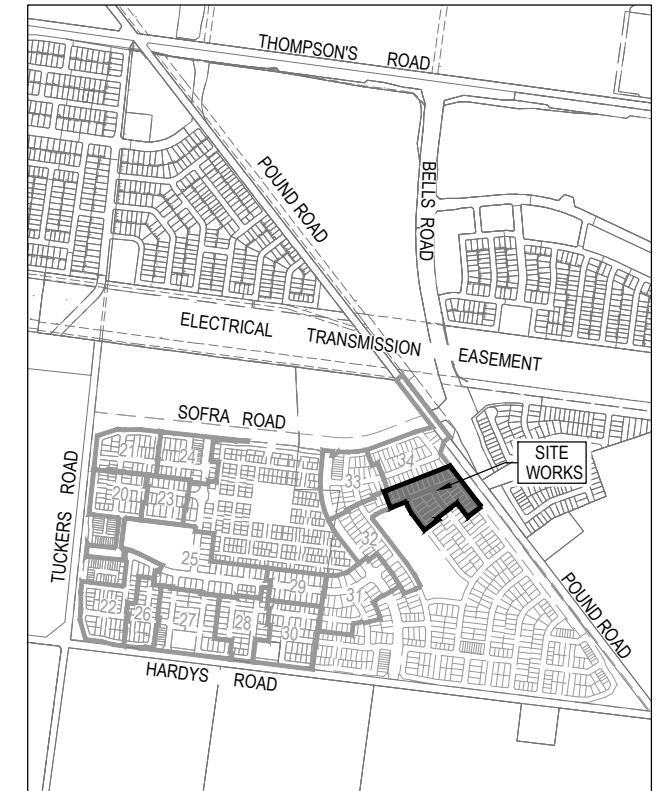

SITE PLAN

NOT TO SCALE

MELWAY REF: 135 F4

Survey Origin:

Coordinates are on a local plane datum based upon MGA2020 Zone 55 bearings and truncated MGA2020 Zone 55 co-ordinates at PM77. Heights are to AHD vide Permanent Mark PM 56 (Cranbourne) RL 26.71 Bearing Datum is MGA2020 Zone 55 which has been derived by our GPSnet Survey.

Plane Grid Coordinates to MGA2020 Zone 55 Grid Coordinates Conversion.

(PLANE SHIFT) Add + 353,823.586 to Eastings
Add +5,780,840.520 to Northings
(APPLY SCALE FACTOR) Scale by 0.999846 at point PM77

ISSUED FOR CONSTRUCTION

REV	DESCRIPTION	DATE	DRN.	APP.	REV	DESCRIPTION	DATE	DRN.	APP.
A	ISSUED FOR CONSTRUCTION	06.06.22	N.T.	M.F.					



Designed
Date N. IVETIC
28.04.2022

Drawn
N. TABUENA

Approved
Date M. FELICIANO
29.04.2022

PS Number
PSS02134A



Project
Details MERIDIAN CENTRAL ESTATE
STAGE 35
CITY OF CASEY

Drawing
Title COVER SHEET

Sheet 01 of 17

Scale

Project Ref
1801767

Stage No
35

Drawing No
001

Rev
A



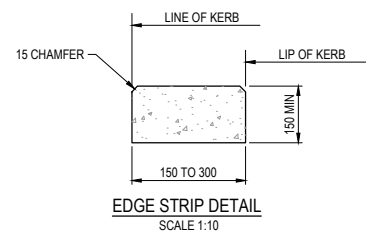
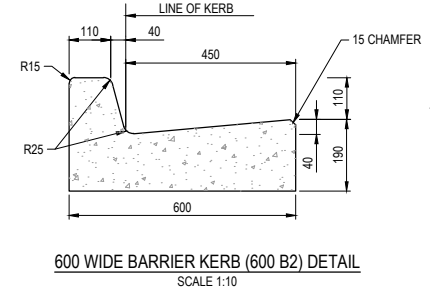
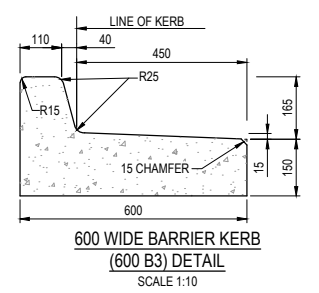
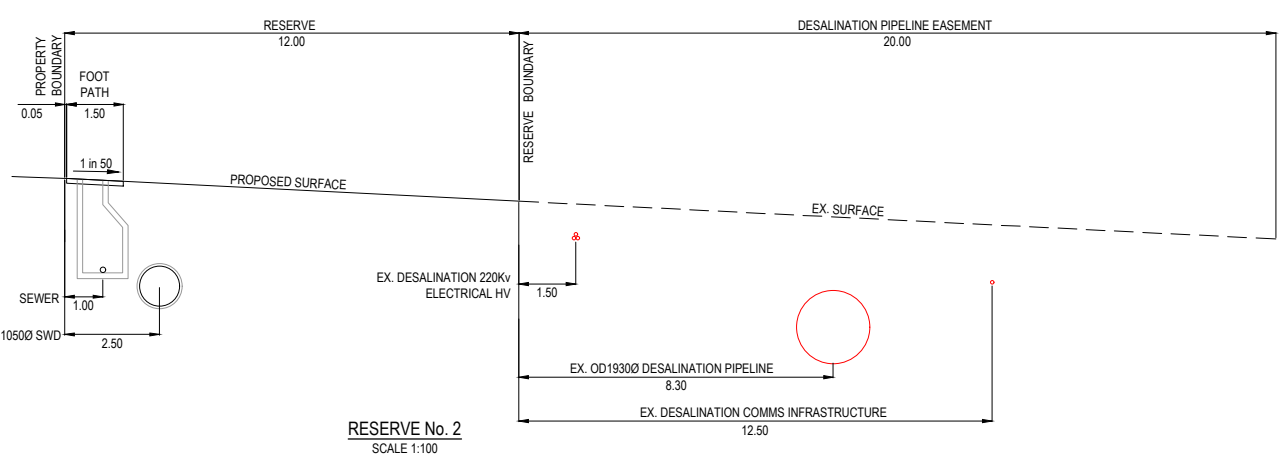
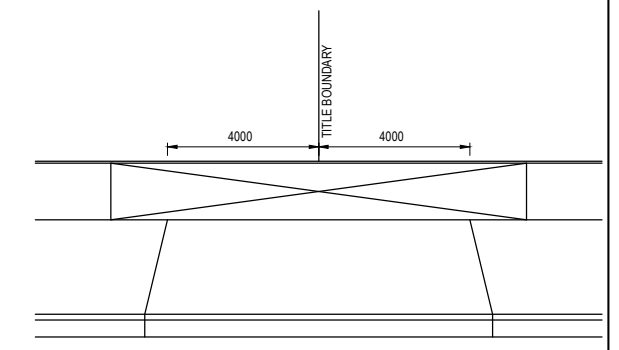
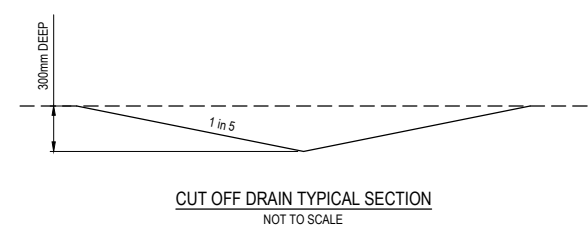
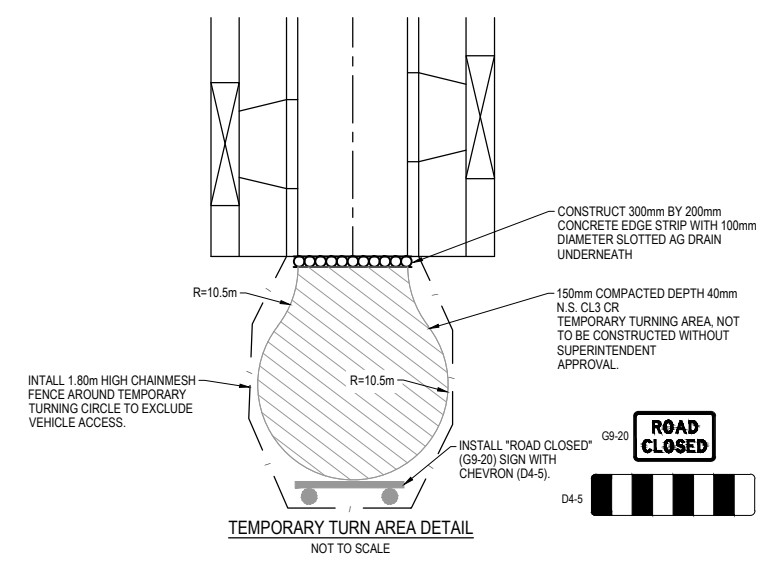
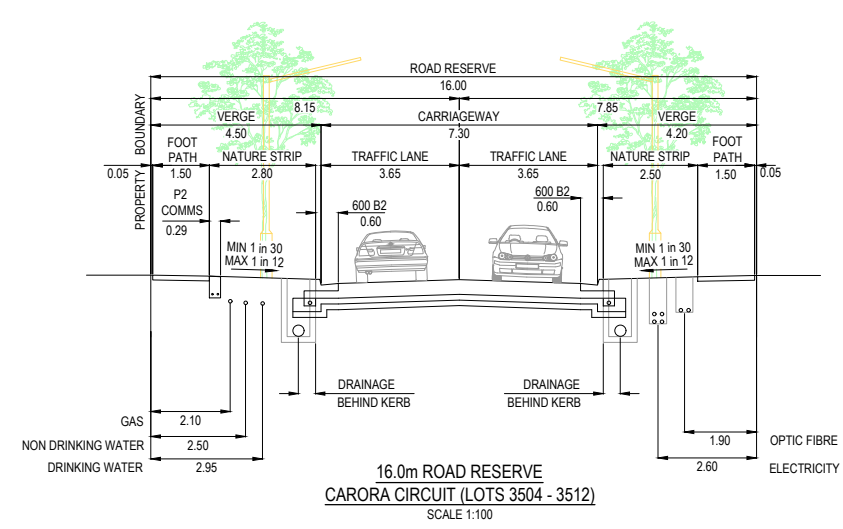
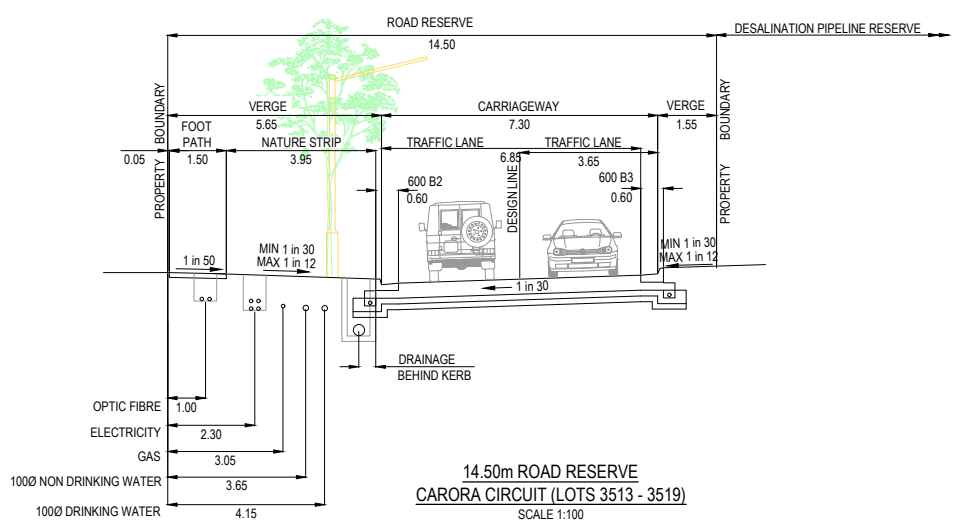
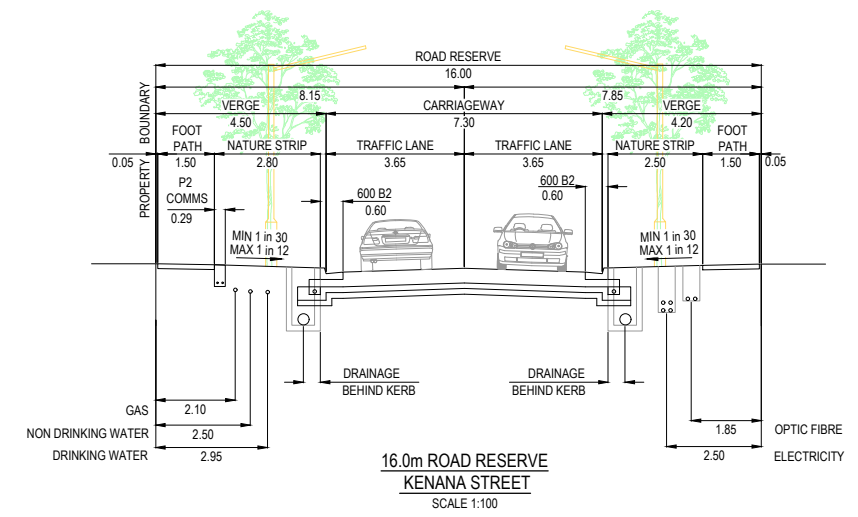
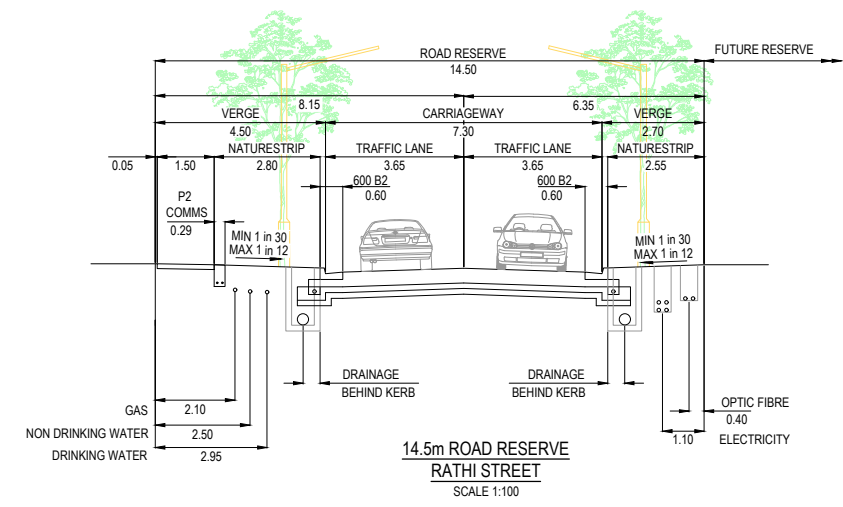
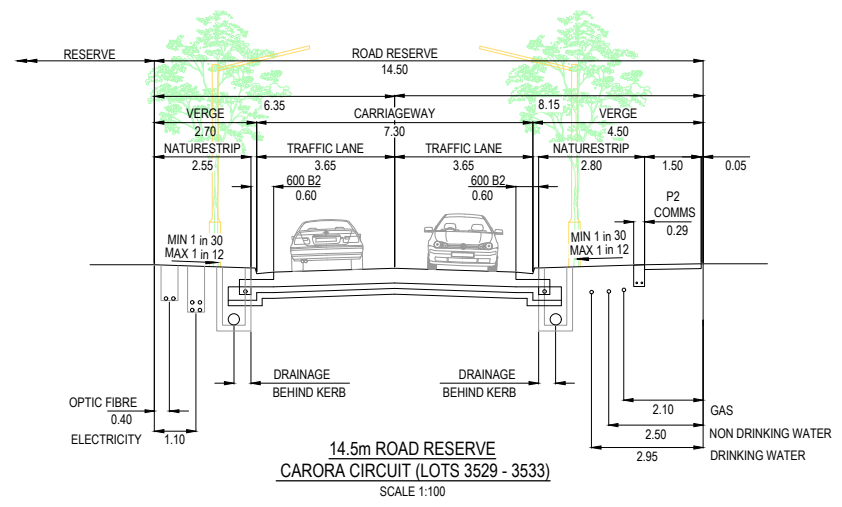

NOTES
1. REFER TO EDM 502 FOR FURTHER DETAILS

ISSUED FOR CONSTRUCTION

REV	DESCRIPTION	DATE	DRN.	APP.	REV	DESCRIPTION	DATE	DRN.	APP.
A	ISSUED FOR CONSTRUCTION	06.06.22	N.T.	M.F.					



Designed: N. IVETIC
Date: 28.04.2022
Drawn: N. TABUENA
Approved: M. FELICIANO
Date: 29.04.2022
PS Number: PSS02134A

Beveridge Williams
1 Glenferrie Road
Malvern VIC 3144
ph: 03 9524 8888
www.beveridgewilliams.com.au

Project: MERIDIAN CENTRAL ESTATE
STAGE 35
CITY OF CASEY
Drawing Title: TYPICAL ROAD CROSS SECTIONS AND GENERAL DETAILS

Sheet 02 of 17
Scale: AS SHOWN
Project Ref: 1801767
Stage No: 35
Drawing No: 002
Rev: A

K:\Jobs Data\1801767 - Meridian_Eng\Stage 35\Drawings\1801767-35-002-DET.dwg

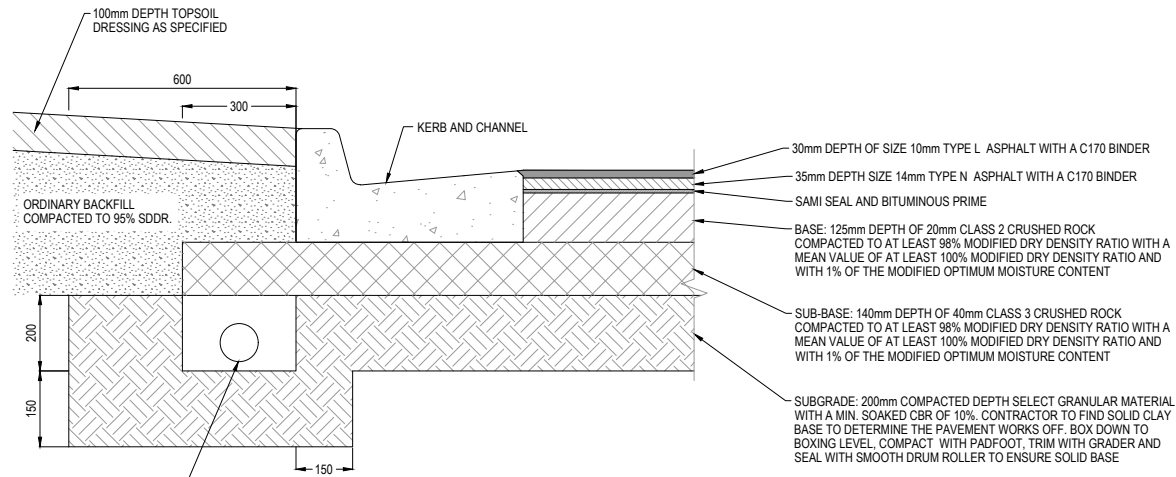

PAVEMENT COMPOSITION
RATHI CIRCUIT, CARORA CIRCUIT & KENANA STREET
530mm DEPTH
 N.T.S.
 REFER STANDARD DRAWING
 EDMC 202 FOR DETAILS.

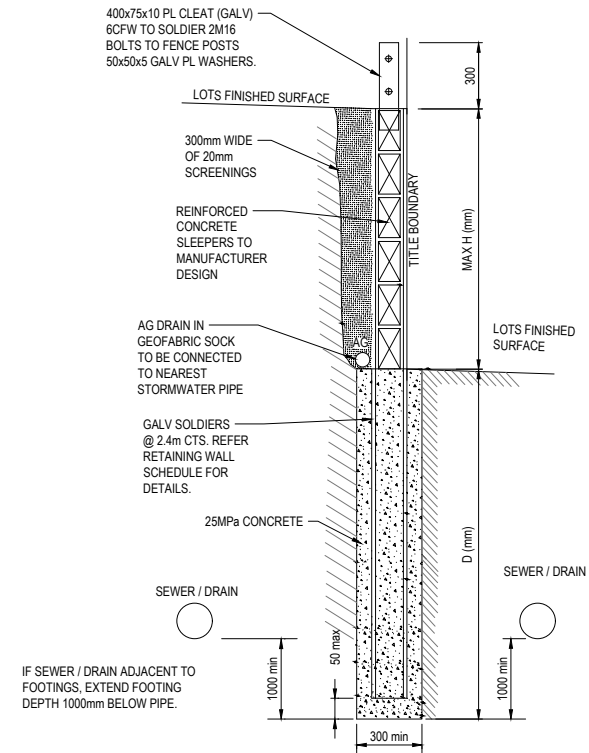

**CONCRETE SLEEPER
 RETAINING WALL DETAILS**
 NTS

HEIGHT - H(mm)	DEPTH - D(mm)	SOLDIERS SIZE @ 2.4m CTS
600	900	100 UC 14.8
800	1200	100 UC 14.8
1000	1500	100 UC 14.8

D min TO BE GREATER OF THAT SHOWN ABOVE OR 1000mm BELOW ADJACENT SEWER / DRAINAGE

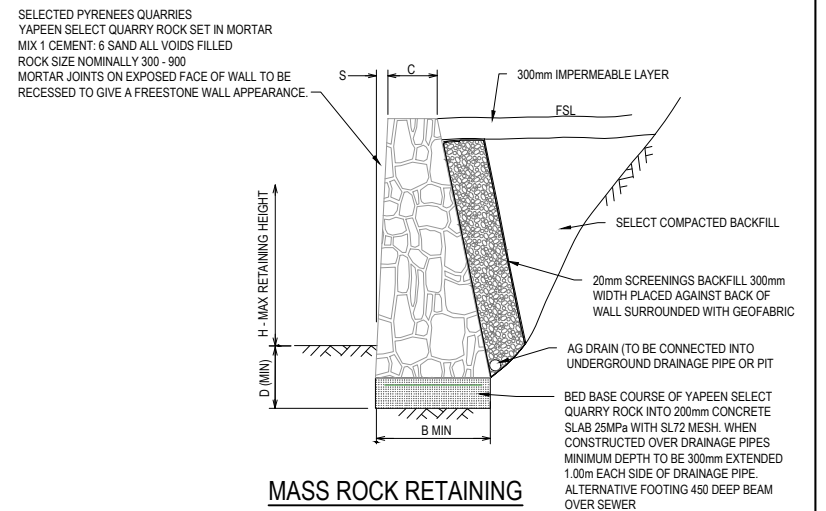

**MASS ROCK RETAINING
 WALL DETAIL (TYPE RR)**
 NTS

MAX WALL HEIGHT-H(mm)	FOUNDING DEPTH-D(mm)	BASE WIDTH - B(mm)	FRONT FACE SETBACK-S (mm)	CREST WIDTH-C(mm)
400	400	450	15	300
500	400	500	15	300
600	400	500	30	300
800	400	600	30	300
1000	400	700	30	300

- RETAINING WALL NOTE R.1
 a. WHERE FOOTPATH ABUTS RETAINING WALL CONTINUE CONCRETE UP TO BASE OF RETAINING WALL.
- FOOTING NOTE F.2
 a. TOE OF WALL SHALL PENETRATE THROUGH ANY FILL MATERIAL & THE NATURAL SILT SOILS TO BE FOUND AT LEAST 100mm INTO THIS UNDERLYING NATURAL STILL CLAY OR WEATHERED ROCK.
 ALL EXCAVATIONS SHALL HAVE FOUNDING DEPTHS AND BEARING CAPACITY APPROVED BY THE ENGINEER OR BUILDING SURVEYOR BEFORE CONCRETE IS PLACED.
 FOOTING EXCAVATIONS WHICH ARE DEEPER TO PENETRATE THROUGH UNSUITABLE SOILS SHALL BE BACKFILLED UP TO UNDERSIDE OF FOOTINGS WITH 15 MPa BLINDING CONCRETE.
 b. ALL EXCAVATION FOUNDING SURFACES SHALL BE LEVEL (NOT INCLINED) CLEAN CUT & FREE OF MUD OR WATER.
 c. ALL SEEPAGE INFLOW SHALL BE REMOVED BEFORE PLACEMENT OF CONCRETE.
 d. FOOTINGS SHALL BE FOUND IN STIFF NATURAL CLAY HAVING A SAFE BEARING CAPACITY OF 150Kpa.

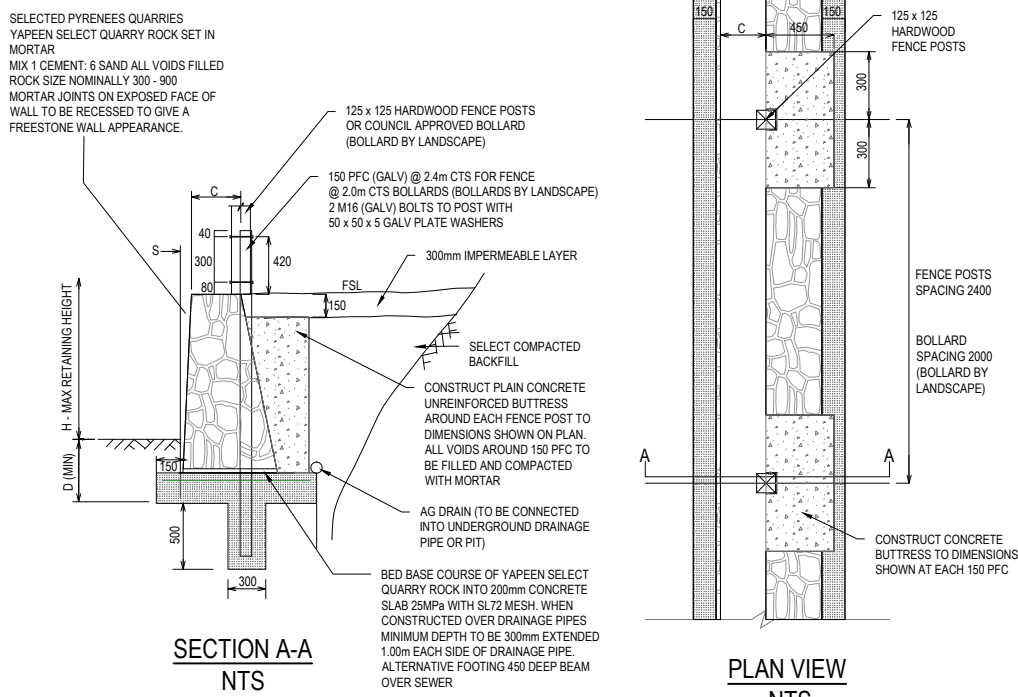

**MASS ROCK RETAINING WALL DETAIL WITH
 PALING TIMBER FENCE (TYPE RR) OR BOLLARD
 (BOLLARD BY LANDSCAPE)**
 NTS

**ISSUED FOR
 CONSTRUCTION**

REV	DESCRIPTION	DATE	DRN.	APP.	REV	DESCRIPTION	DATE	DRN.	APP.
A	ISSUED FOR CONSTRUCTION	06.06.22	N.T.	M.F.					



Designed
 Date
 Drawn
 Approved
 Date
 PS Number



Project Details
 MERIDIAN CENTRAL ESTATE
 STAGE 35
 CITY OF CASEY
 Drawing Title
 RETAINING WALL DETAILS
 AND PAVEMENT MAKEUP

Sheet 03 of 17	
Scale AS SHOWN	
Project Ref 1801767	Stage No 35
Drawing No 003	Rev A

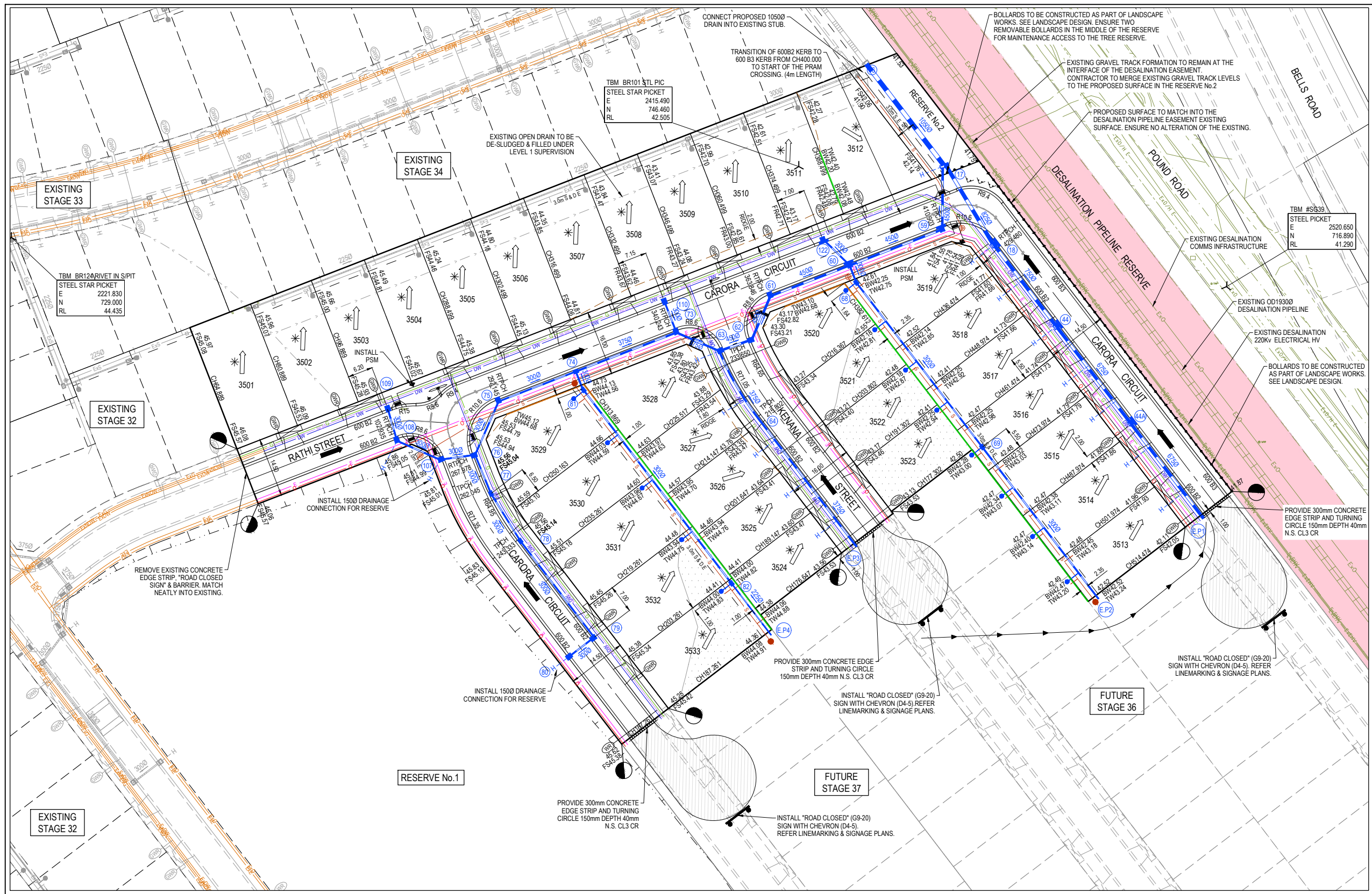

LEGEND - LAYOUT PLAN

- STORMWATER DRAIN, PIT & PROPERTY INLET
- MELBOURNE WATER DRAIN & PIT
- SWALE DRAIN
- SEWER & MAINTENANCE STRUCTURES
- HOUSE DRAIN
- SERVICE CONDUITS
- TACTILE PAVERS (INDICATIVE ONLY)
- ELECTRICITY (UNDERGROUND)
- ELECTRICITY (OVERHEAD)
- OPTIC FIBRE
- TELECOMMUNICATIONS
- GAS
- WATER
- RECYCLED WATER
- EXISTING ELECTRICITY (UNDERGROUND)
- EXISTING ELECTRICITY (OVERHEAD)
- EXISTING GAS
- EXISTING OPTIC FIBRE
- EXISTING TELECOMMUNICATIONS
- EXISTING WATER
- EXISTING RECYCLED WATER
- EXISTING STORMWATER DRAIN
- EXISTING MELBOURNE WATER DRAIN
- EXISTING SEWER
- EXISTING HOUSE DRAIN
- EXISTING SWALE DRAIN
- EXISTING SURFACE LEVEL
- FINISHED BUILDING LINE LEVEL
- FINISHED RIDGE LINE LEVEL
- TOP OF RETAINING WALL
- BOTTOM OF RETAINING WALL
- RIDGE LINE
- MASS ROCK RETAINING WALL
- CONCRETE SLEEPER RETAINING WALL
- EXISTING CONCRETE SLEEPER RETAINING WALL
- ZERO LOT LINES
- PAVEMENT TREATMENT
- STRUCTURAL FILL > 200mm DEEP
- EX. STRUCTURAL FILL > 200mm DEEP
- DIRECTION OF FALL
- OVERLAND FLOW
- ALLOTMENT TO BE GRADED EVENLY IN DIRECTION OF FALL TO LEVELS INDICATED
- CONCRETE EDGE STRIP WITH SUBSOIL DRAIN, "NO ROAD" SIGN & BARRIER
- LIMIT OF WORKS
- EXISTING TREE TO BE REMOVED
- PERMANENT SURVEY MARK
- TEMPORARY BENCH MARK
- PROPOSED DRIVEWAY
- TREE PROTECTION ZONE (TPZ)

WARNING! (NO GO ZONE)
 NO WORKS TO BE COMMENCED WITHIN THE EXISTING DESALINATION EASEMENT OR OVER THE EXISTING 220KV HV ELEC, 19000 DESAL PIPELINE & OPTIC CABLE WITHOUT PRIOR WRITTEN APPROVAL FROM DELWP AND AUSNET.

DANGER!
 OVERHEAD ELECTRICITY
 CONTRACTOR TO EXERCISE EXTREME CAUTION WHEN OPERATING IN THE VICINITY OF THESE LINES. THE CONTRACTOR MUST ADHERE TO ALL "NO GO ZONE" REQUIREMENTS OF THE POWER AUTHORITY.

WARNING
BWARE OF UNDERGROUND SERVICES
 The locations of underground services are approximate only and their exact position should be proven on site. No guarantee is given that all existing services are shown. Locate all underground services before commencement of works
DIAL 1100 BEFORE YOU DIG
 www.1100.com.au

SERVICE OFFSET TABLE

Location	Gas		ND - Water		Water		Electricity		Telecommunication		Sewer	
	Side	Offset (m)	Side	Offset (m)	Side	Offset (m)	Side	Offset (m)	Side	Offset (m)	Side	Offset (m)
RATHI STREET	N	2.10	N	2.50	N	2.95	S	1.10	S	0.40	-	-
CARORA CIRCUIT (LOTS 3529-3533)	E	2.10	E	2.50	E	2.95	W	1.10	W	0.40	-	-
CARORA CIRCUIT (LOTS 3513-3519)	W	3.05	W	3.65	W	4.15	W	2.30	W	0.80	-	-
CARORA CIRCUIT (LOTS 3504-3512)	N	2.10	N	2.50	N	2.95	S	2.60	S	1.85	S	1.00
KENANA STREET	W	2.10	W	2.50	W	2.95	E	2.50	E	1.80	-	-

NOTE: STREET TREES ARE TO BE PLANTED IN THE CENTRE OF ALL NATURE STRIPS

ROAD LAYOUT TABLE

Road Name	Reserve Width (m)	Road Width (m)			Kerb Type		Verge Width (m)	
		Lip to Lip	Inv to Inv	Back to Back	Nth/West	Sth/East	Nth/West	Sth/East
RATHI STREET	14.50	6.40	7.30	7.60	600 B2	600 B2	4.50	2.70
CARORA CIRCUIT (LOTS 3529-3533)	14.50	6.40	7.30	7.60	600 B2	600 B2	4.50	2.70
CARORA CIRCUIT (LOTS 3513-3519)	14.50	6.40	7.30	7.60	600 B3	600 B2	1.55	5.65
CARORA CIRCUIT (LOTS 3504-3512)	16.00	6.40	7.30	7.60	600 B2	600 B2	4.50	4.20
KENANA STREET	16.00	6.40	7.30	7.60	600 B2	600 B2	4.50	4.20

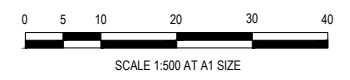

ISSUED FOR CONSTRUCTION

REV	DESCRIPTION	DATE	DRN.	APP.	REV	DESCRIPTION	DATE	DRN.	APP.
A	ISSUED FOR CONSTRUCTION	06.06.22	N.T.	M.F.					



Designed Date: N. IVETIC 28.04.2022
 Drawn: N. TABUENA
 Approved Date: M. FELICIANO 29.04.2022
 PS Number: PS902134A

Beveridge Williams
 1 Glenferrie Road
 Malvern VIC 3144
 ph: 03 9524 8888
 www.beveridgewilliams.com.au

Project Details: MERIDIAN CENTRAL ESTATE
 STAGE 35
 CITY OF CASEY

Drawing Title: LAYOUT PLAN

Sheet 04 of 17
 Scale: 1:500 @ A1
 Project Ref: 1801767
 Stage No: 35
 Drawing No: 010
 Rev: A

K:\Jobs Data\1801767 - Meridian_Eng\Stage 35\Drawings\1801767-35-010-LAY.dwg

LEGEND	
	EXISTING SURFACE
	DESIGN LINE
	FUTURE DESIGN LINE
	EXISTING SURFACE AT SOUTH / WEST BOUNDARY
	SOUTH / WEST LIP OF KERB
	EXISTING SURFACE AT NORTH / EAST BOUNDARY
	NORTH / EAST LIP OF KERB

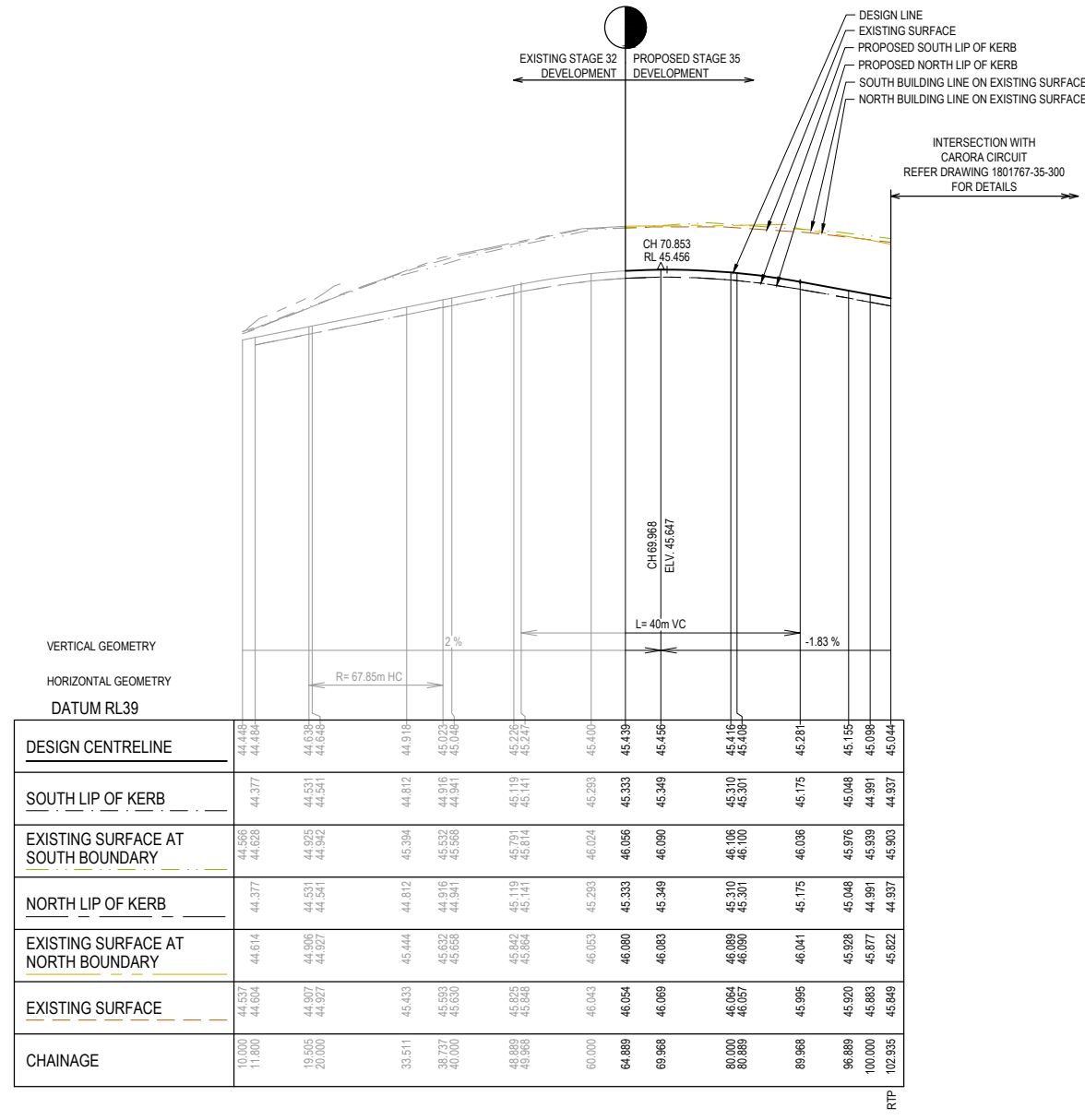

RATHI STREET - ROAD LONGITUDINAL SECTION

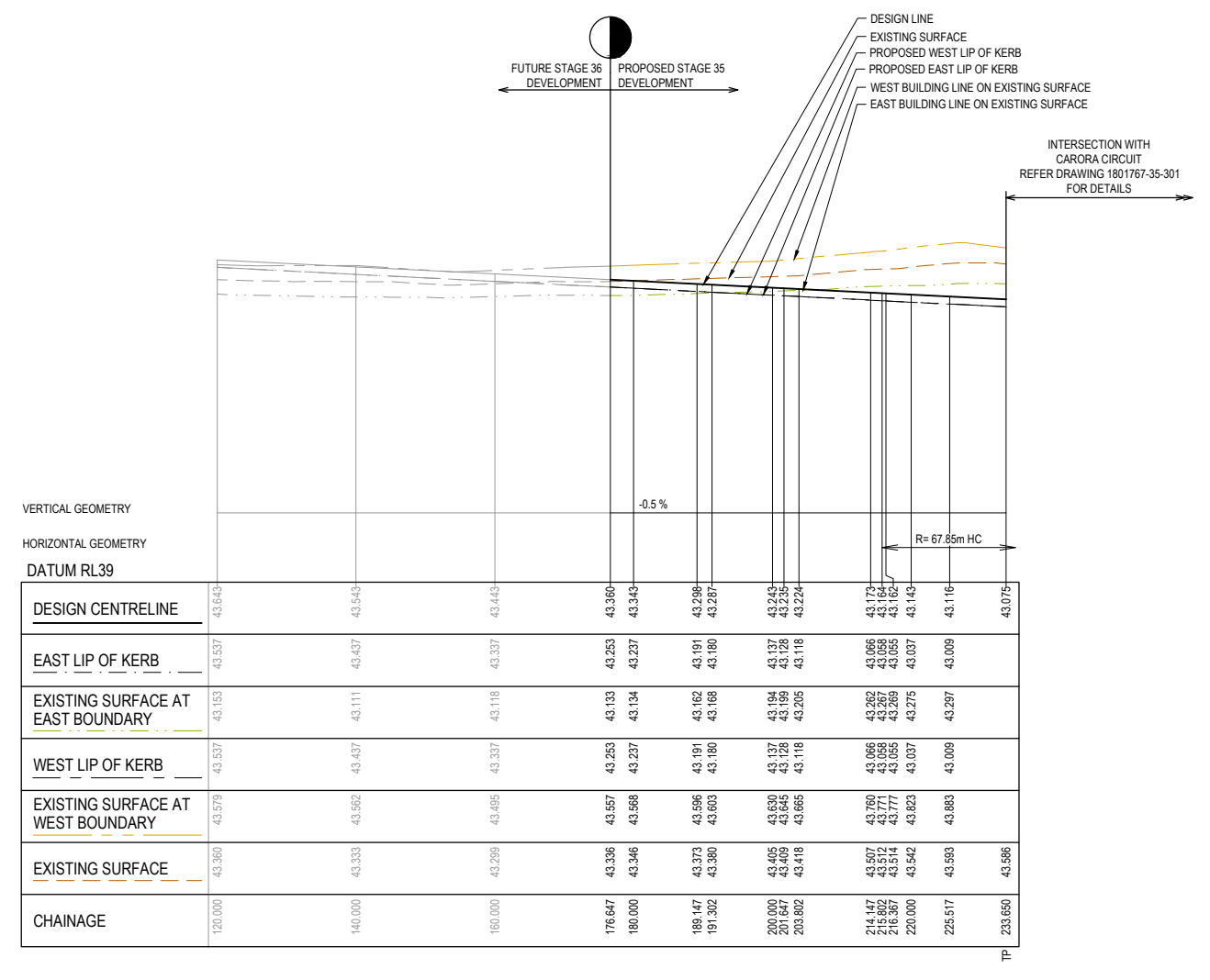

KENANA STREET - ROAD LONGITUDINAL SECTION

ISSUED FOR CONSTRUCTION

© COPYRIGHT All rights reserved Beveridge Williams & Co. Pty Ltd has granted a licence to the principle to use this document for its intended purpose. No unauthorized copying is permitted						
REV	DESCRIPTION	DATE	DRN.	APP.	REV	DESCRIPTION
A	ISSUED FOR CONSTRUCTION	06.06.22	N.T.	M.F.		

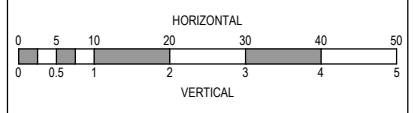

Designed	N. IVETIC
Date	28.04.2022
Drawn	N. TABUENA
Approved	M. FELICIANO
Date	29.04.2022
PS Number	PS902134A



Project Details	MERIDIAN CENTRAL ESTATE STAGE 35 CITY OF CASEY
Drawing Title	ROAD LONGITUDINAL SECTIONS RATHI STREET AND KENANA STREET

Sheet 05 of 17
Scale 1:500 H 1:50 V @ A1
Project Ref 1801767
Stage No 35
Drawing No 100
Rev A

K:\Jobs Data\1801767 - Meridian_Eng\Stage 35\Drawings\1801767-35-100-RLS.dwg

LEGEND	
	EXISTING SURFACE
	DESIGN LINE
	FUTURE DESIGN LINE
	EXISTING SURFACE AT SOUTH / WEST BOUNDARY
	SOUTH / WEST LIP OF KERB
	EXISTING SURFACE AT NORTH / EAST BOUNDARY
	NORTH / EAST LIP OF KERB

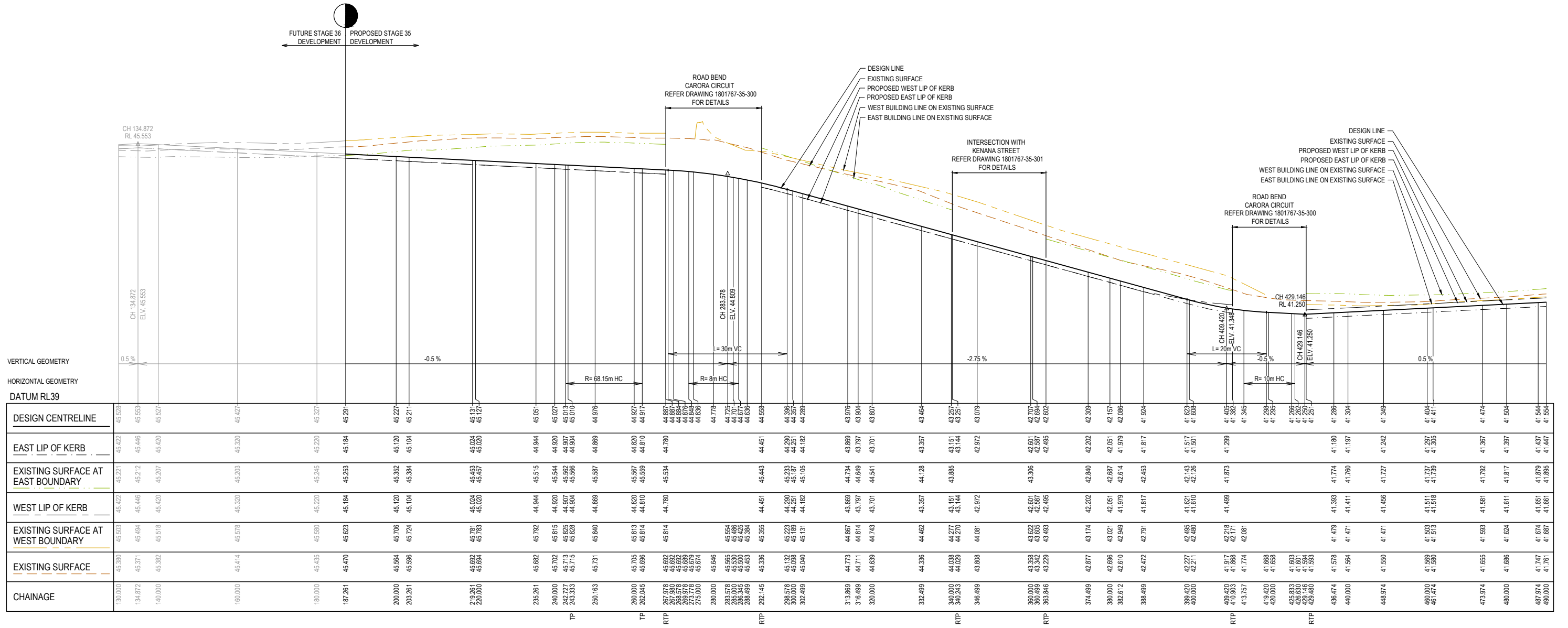

CARORA CIRCUIT - ROAD LONGITUDINAL SECTION

ISSUED FOR CONSTRUCTION

REV	DESCRIPTION	DATE	DRN.	APP.	REV	DESCRIPTION	DATE	DRN.	APP.
A	ISSUED FOR CONSTRUCTION	06.06.22	N.T.	M.F.					

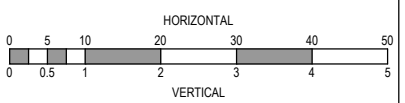

Designed
Date
28.04.2022

Drawn
N. TABUENA

Approved
Date
29.04.2022

PS Number
PS902134A

BW Beveridge Williams

1 Glenferrie Road
Malvern VIC 3144
ph: 03 9524 8888
www.beveridgewilliams.com.au

Project Details
MERIDIAN CENTRAL ESTATE
STAGE 35
CITY OF CASEY

Drawing Title
ROAD LONGITUDINAL SECTIONS
(SHEET 1 OF 2)

Sheet 06 of 17

Scale
1:500 H 1:50 V @ A1

Project Ref
1801767

Stage No
35

Drawing No
101

Rev
A

K:\Jobs Data\1801767 - Meridian_Eng\Stage 35\Drawings\1801767-35-100-RLS.dwg

LEGEND	
	EXISTING SURFACE
	DESIGN LINE
	FUTURE DESIGN LINE
	EXISTING SURFACE AT SOUTH BOUNDARY
	SOUTH LIP OF KERB
	EXISTING SURFACE AT NORTH BOUNDARY
	NORTH LIP OF KERB

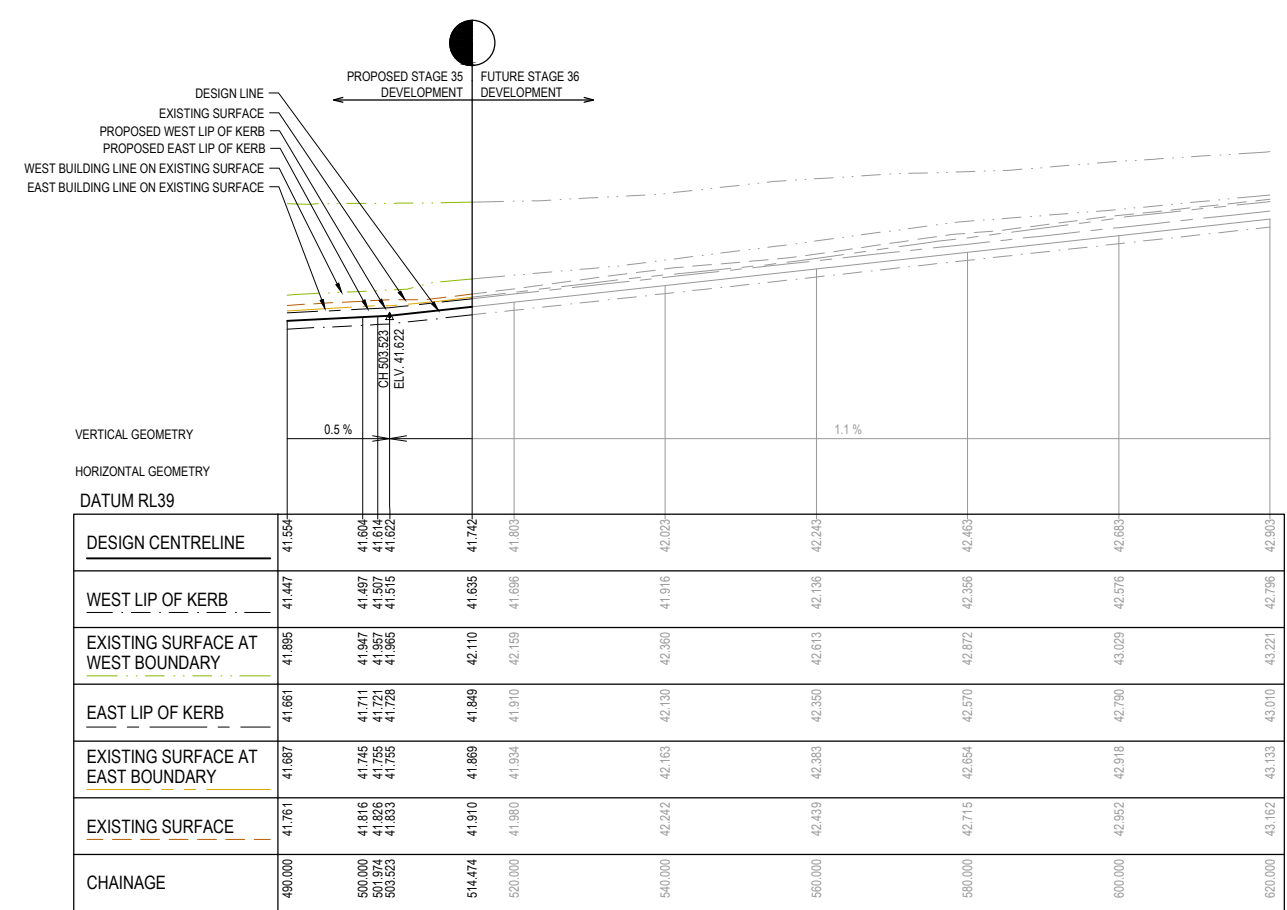

CARORA CIRCUIT - ROAD LONGITUDINAL SECTION (continued)

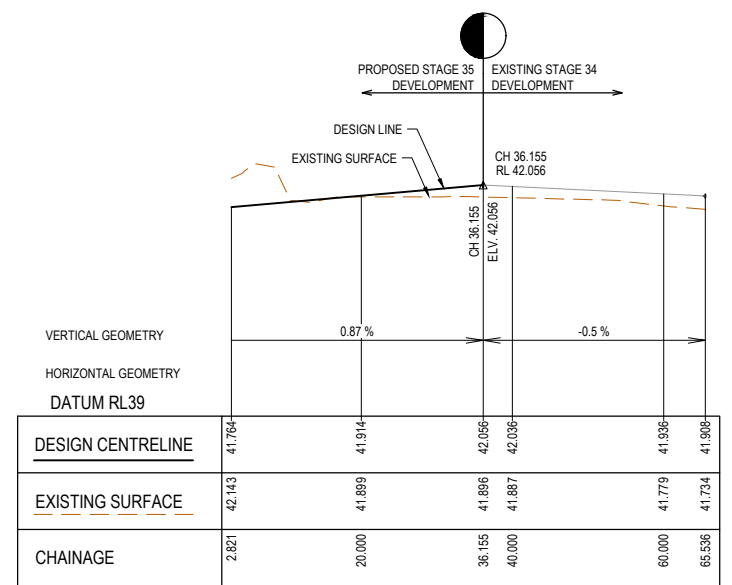

RESERVE No.2 FOOTPATH - LONGITUDINAL SECTION

ISSUED FOR CONSTRUCTION

REV	DESCRIPTION	DATE	DRN.	APP.	REV	DESCRIPTION	DATE	DRN.	APP.
A	ISSUED FOR CONSTRUCTION	06.06.22	N.T.	M.F.					

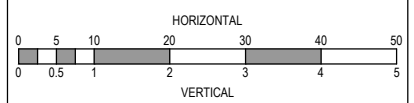

Designed Date: N. IVETIC 28.04.2022
 Drawn: N. TABUENA
 Approved Date: M. FELICIANO 29.04.2022
 PS Number: PSS02134A



Project Details: MERIDIAN CENTRAL ESTATE STAGE 35 CITY OF CASEY
 Drawing Title: ROAD LONGITUDINAL SECTIONS CARORA CIRCUIT - (SHEET 2 OF 2) & RESERVE FOOTPATH

Sheet 07 of 17
 Scale: 1:500 H 1:50 V @ A1
 Project Ref: 1801767 Stage No: 35 Drawing No: 102 Rev: A

K:\Jobs Data\1801767 - Meridian_Eng\Stage 35\Drawings\1801767-35-100-RL.S.dwg

LEGEND	
	EXISTING SURFACE
	DESIGN SURFACE
	STRUCTURAL FILL

STRUCTURAL FILL REQUIRED UNDER PAVEMENT AND FOOTPATHS WHERE CONSTRUCTED ABOVE NATURAL SURFACE. REFER GEOTECH REPORT FOR SPECIFICATION

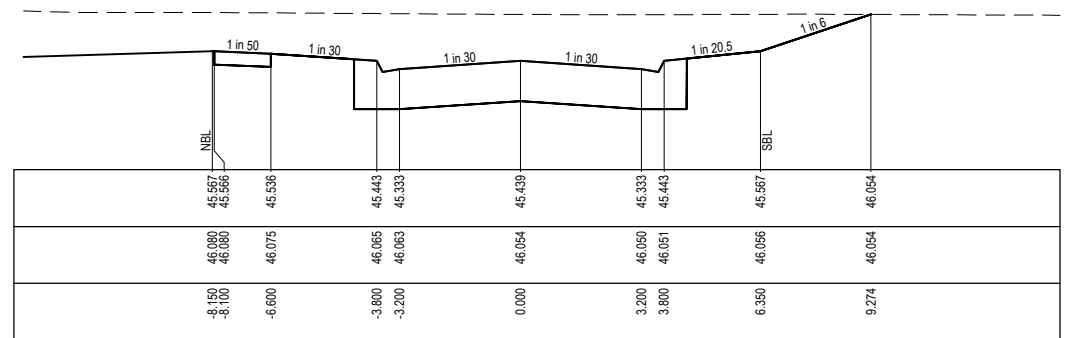
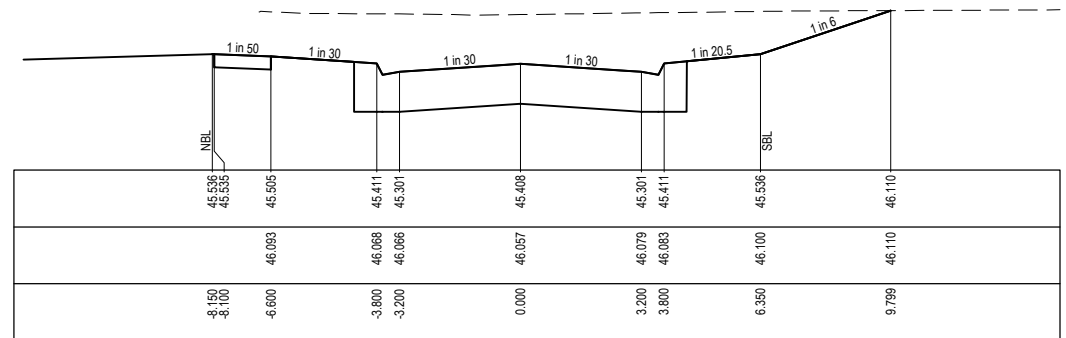
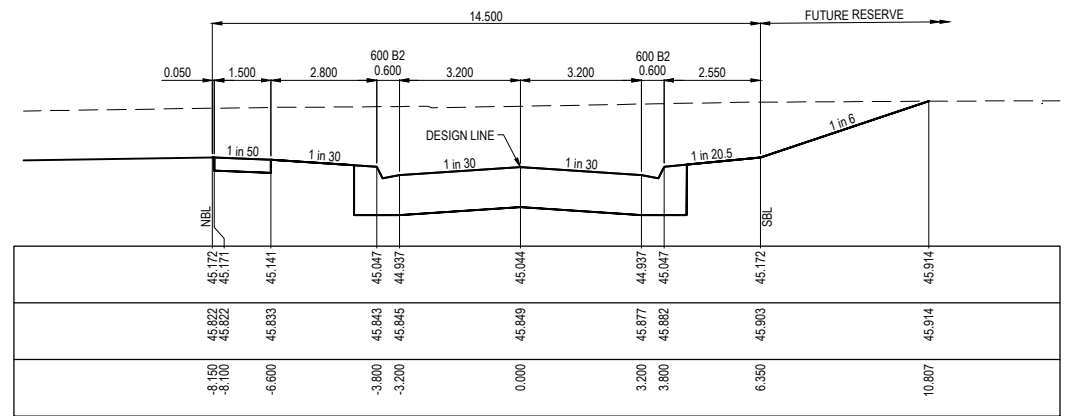

RATHI STREET

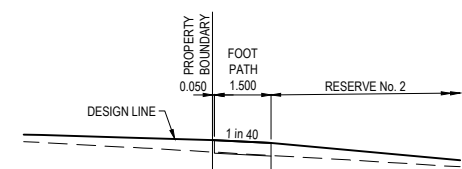

CH 33.335

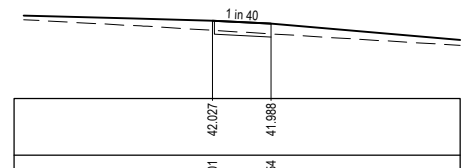

CH 30.000

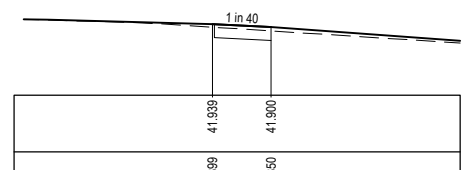

CH 20.000

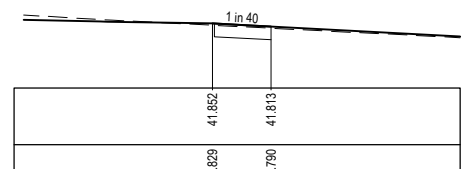

CH 10.000

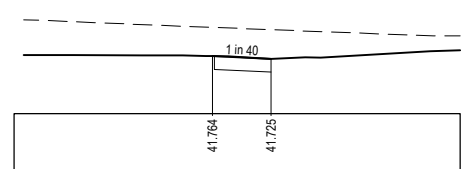

CH 0.000

RESERVE FOOTPATH

ISSUED FOR CONSTRUCTION

© COPYRIGHT All rights reserved Beveridge Williams & Co. Pty Ltd has granted a licence to the principle to use this document for its intended purpose. No unauthorised copying is permitted									
REV	DESCRIPTION	DATE	DRN.	APP.	REV	DESCRIPTION	DATE	DRN.	APP.
A	ISSUED FOR CONSTRUCTION	06.06.22	N.T.	M.F.					

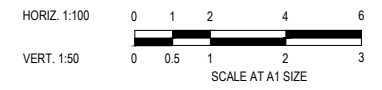

Designed	N. IVETIC
Date	28.04.2022
Drawn	N. TABUENA
Approved	M. FELICIANO
Date	29.04.2022
PS Number	PS902134A



Project Details	MERIDIAN CENTRAL ESTATE STAGE 35 CITY OF CASEY
Drawing Title	ROAD CROSS SECTIONS RATHI STREET & RESERVE FOOTPATH

Sheet 08 of 17	
Scale 1:100 H 1:50 V @ A1	
Project Ref	1801767
Stage No	35
Drawing No	200
Rev	A

K:\Ubsa Data\1801767 - Meridian_Eng\Stage 35\Drawings\1801767-35-200-RXS.dwg

STRUCTURAL FILL REQUIRED UNDER PAVEMENT AND FOOTPATHS WHERE CONSTRUCTED ABOVE NATURAL SURFACE. REFER GEOTECH REPORT FOR SPECIFICATION

LEGEND

--- EXISTING SURFACE
 ——— DESIGN SURFACE
 [Hatched Box] STRUCTURAL FILL

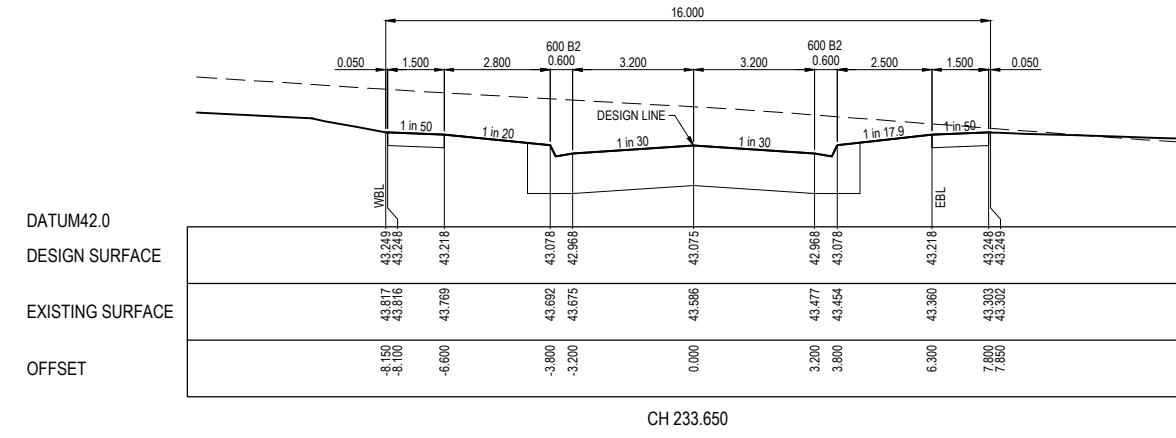

CH 233.650

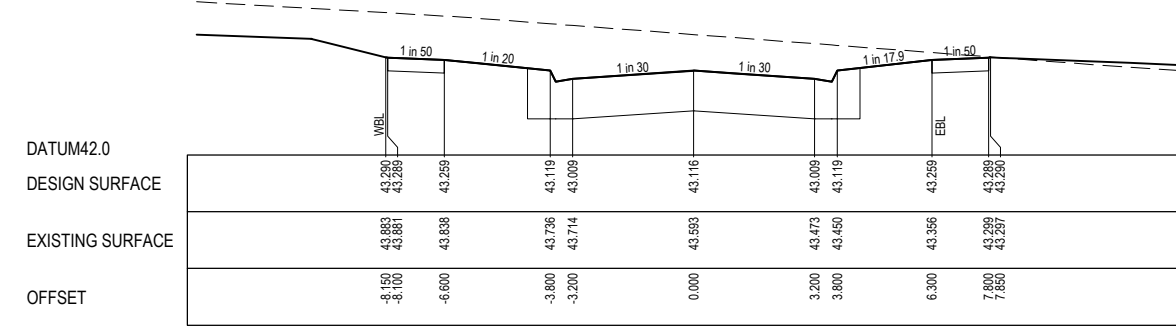

CH 225.517

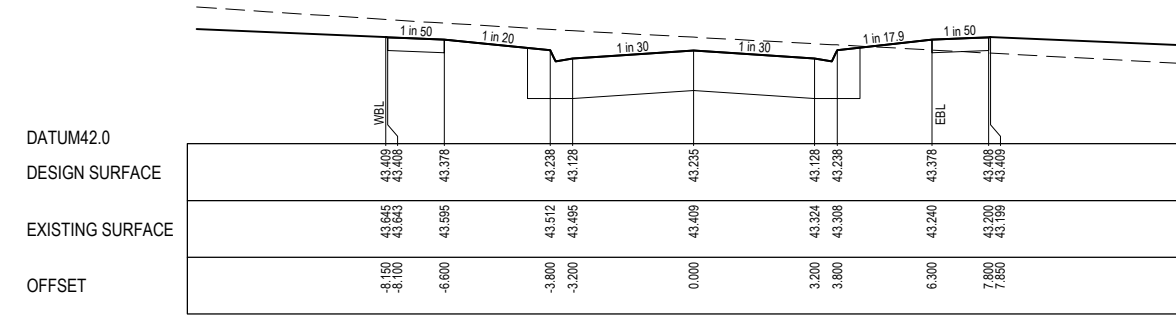

CH 201.647

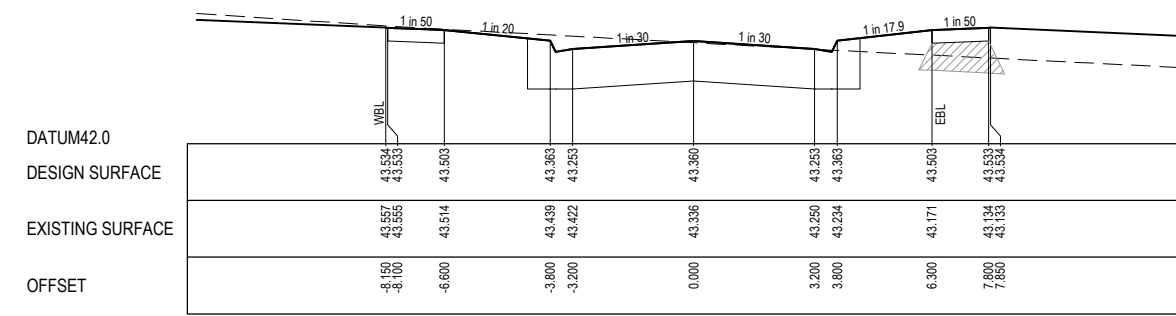

CH 176.647

ISSUED FOR CONSTRUCTION

© COPYRIGHT All rights reserved Beveridge Williams & Co. Pty Ltd has granted a licence to the principle to use this document for its intended purpose. No unauthorised copying is permitted									
REV	DESCRIPTION	DATE	DRN.	APP.	REV	DESCRIPTION	DATE	DRN.	APP.
A	ISSUED FOR CONSTRUCTION	06.06.22	N.T.	M.F.					

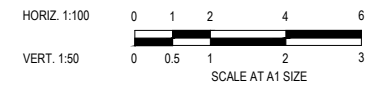

Designed Date: N. IVETIC 28.04.2022
 Drawn: N. TABUENA
 Approved Date: M. FELICIANO 29.04.2022
 PS Number: PSS02134A



Project Details: MERIDIAN CENTRAL ESTATE
 STAGE 35
 CITY OF CASEY
 Drawing Title: ROAD CROSS SECTIONS
 KENANA STREET

Sheet 09 of 17	
Scale: 1:100 H 1:50 V @ A1	
Project Ref: 1801767	Stage No: 35
Drawing No: 201	Rev: A

STRUCTURAL FILL REQUIRED UNDER PAVEMENT AND FOOTPATHS WHERE CONSTRUCTED ABOVE NATURAL SURFACE. REFER GEOTECH REPORT FOR SPECIFICATION

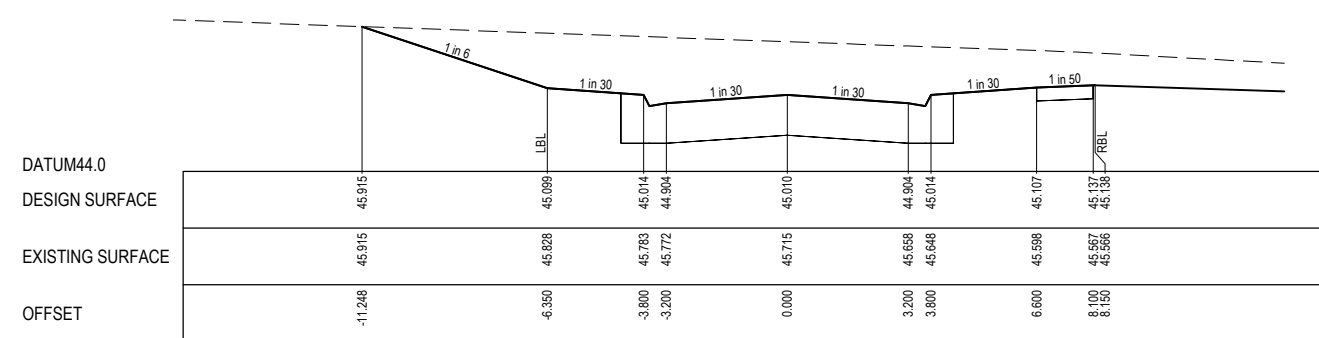
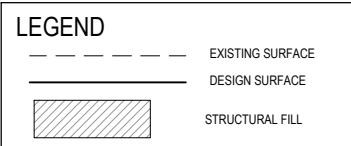

TPCH 243.333

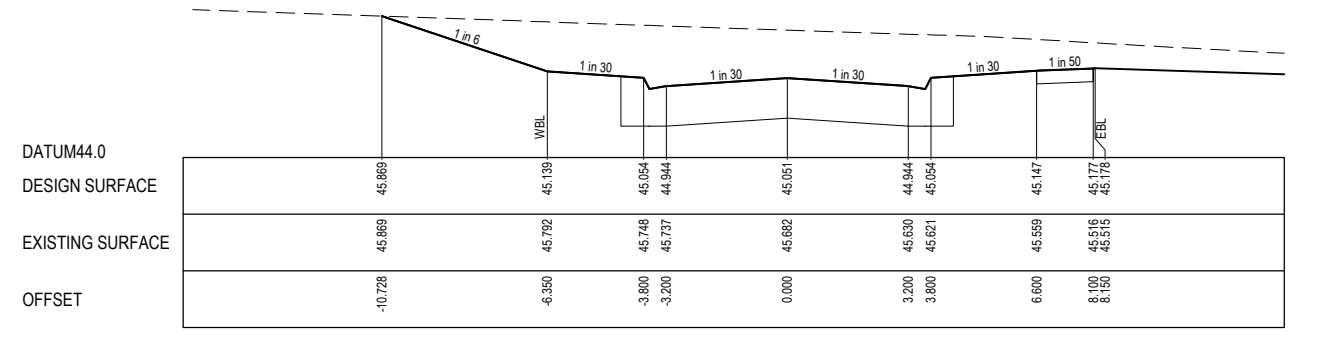

CH 235.261

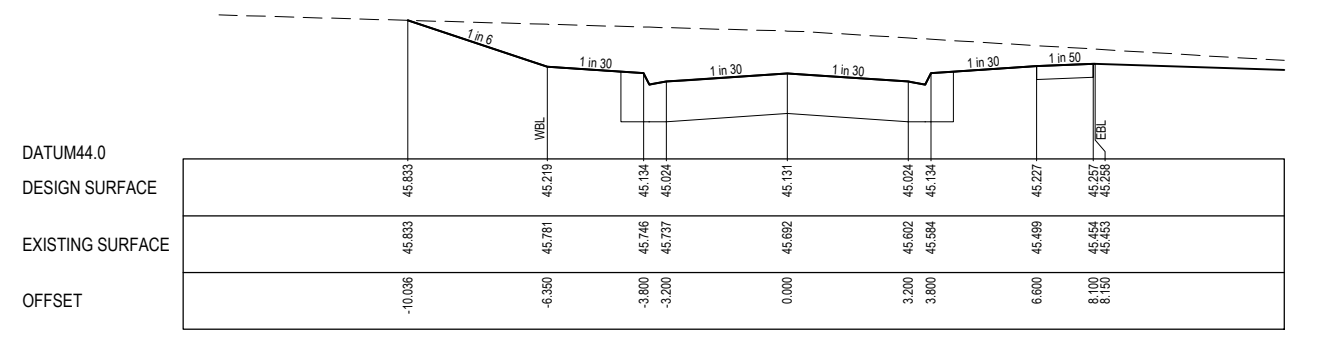

CH 219.261

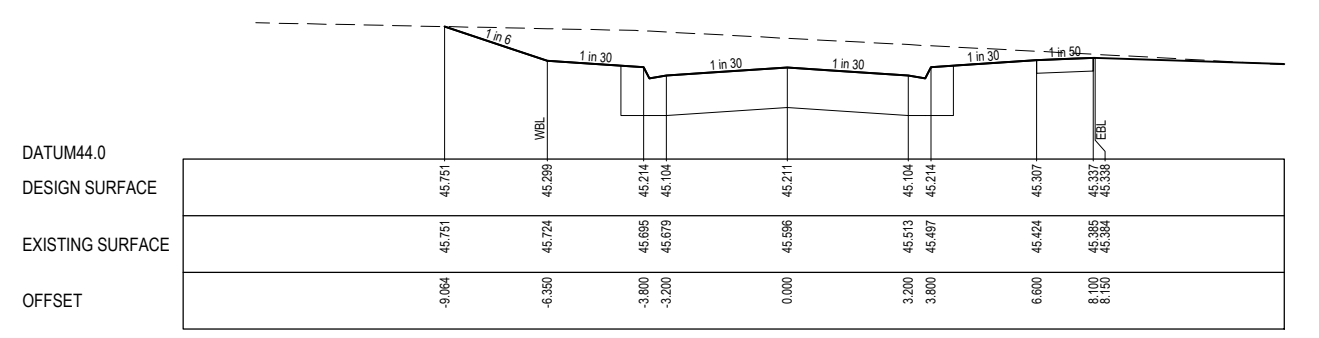

CH 203.261

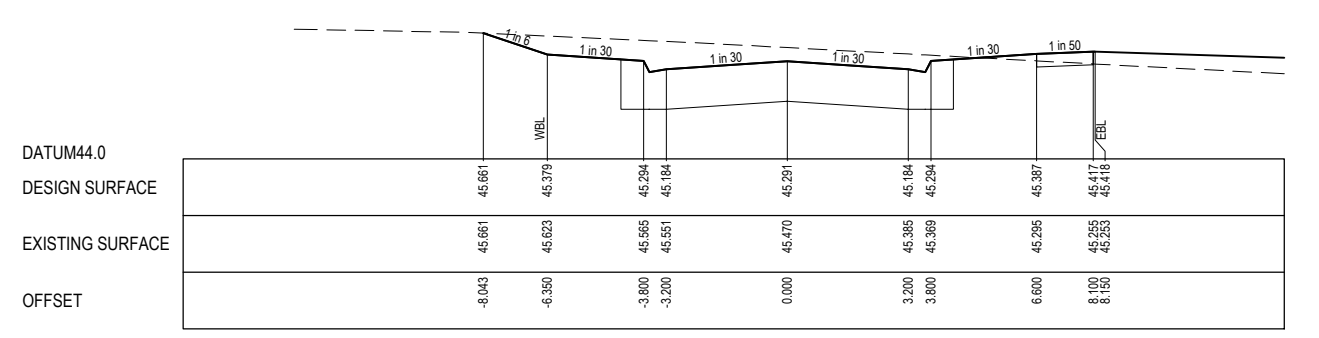

CH 187.261

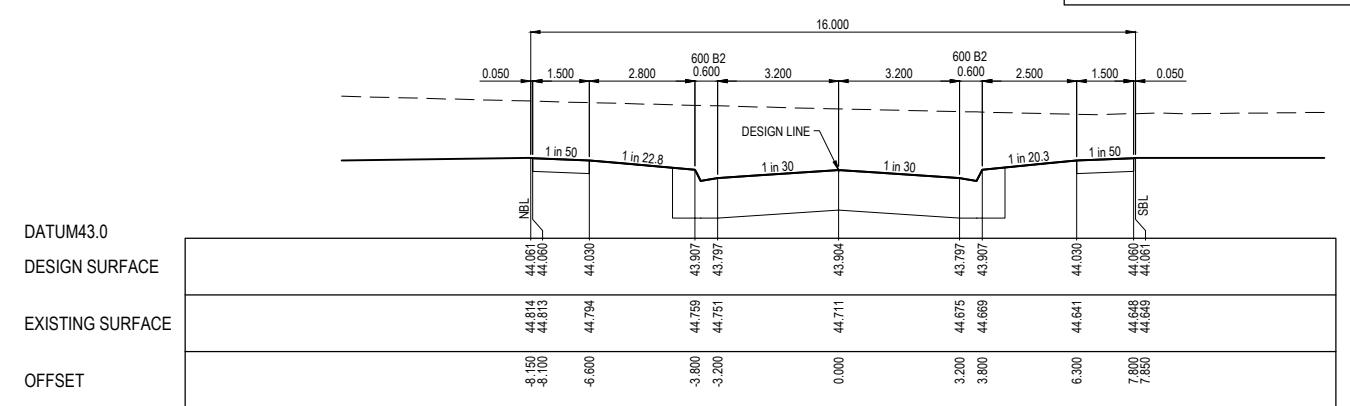

CH 316.499

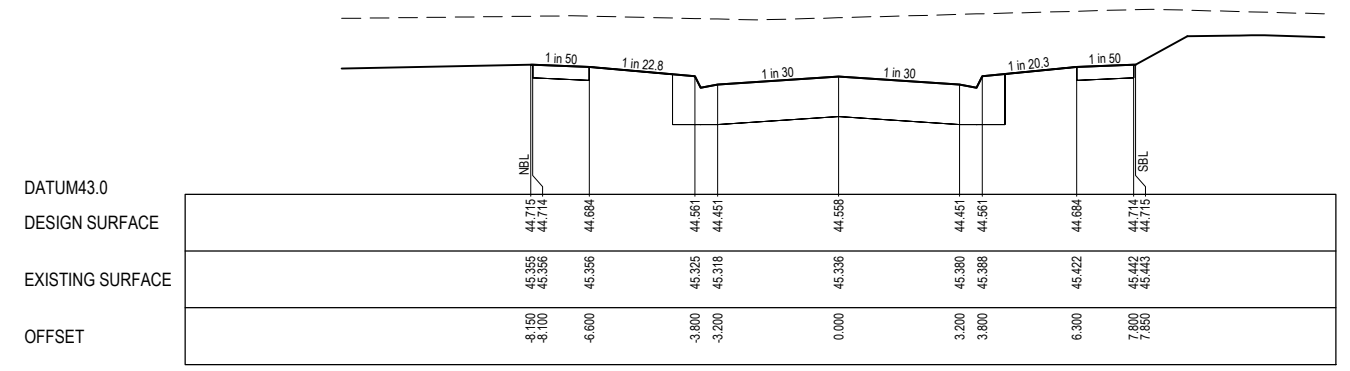

RTPCH 292.145

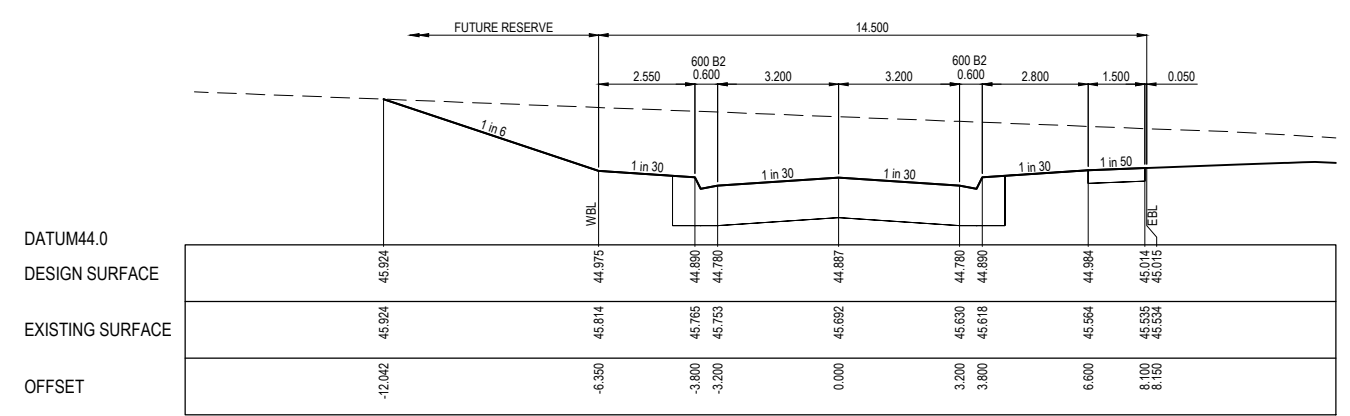

RTPCH 267.978

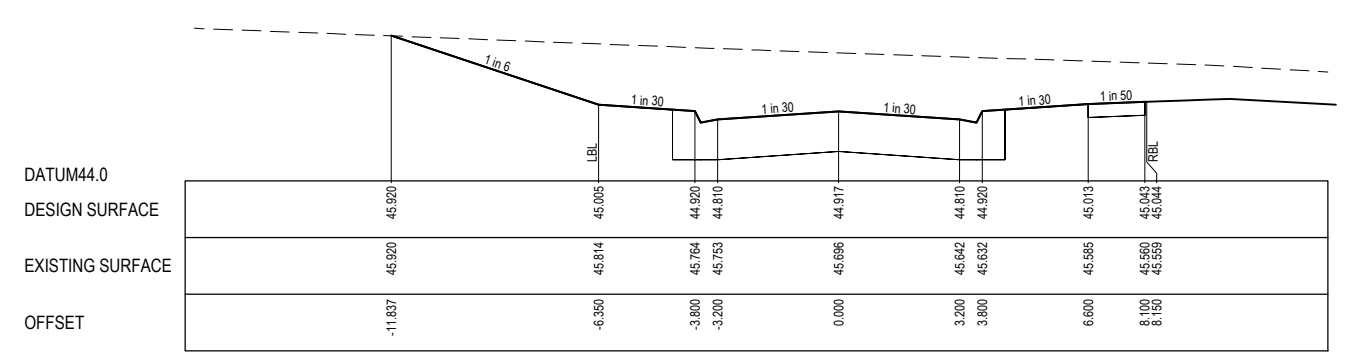

TPCH 262.045

ISSUED FOR CONSTRUCTION

© COPYRIGHT All rights reserved Beveridge Williams & Co. Pty Ltd has granted a licence to the principle to use this document for its intended purpose. No unauthorized copying is permitted									
REV	DESCRIPTION	DATE	DRN.	APP.	REV	DESCRIPTION	DATE	DRN.	APP.
A	ISSUED FOR CONSTRUCTION	06.06.22	N.T.	M.F.					

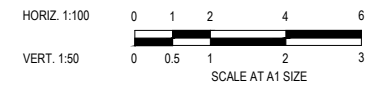

Designed Date: N. IVETIC 28.04.2022
Drawn: N. TABUENA
Approved Date: M. FELICIANO 29.04.2022
PS Number: PPS02134A



Project Details: MERIDIAN CENTRAL ESTATE
STAGE 35
CITY OF CASEY
Drawing Title: ROAD CROSS SECTIONS
CARORA CIRCUIT
(SHEET 1 OF 2)

Sheet 10 of 17
Scale: 1:100 H 1:50 V @ A1
Project Ref: 1801767
Stage No: 35
Drawing No: 202
Rev: A

K:\Jobs Data\1801767 - Meridian_Eng\Stage 35\Drawings\1801767-35-200-RXS.dwg

	EXISTING SURFACE
	DESIGN SURFACE
	STRUCTURAL FILL

STRUCTURAL FILL REQUIRED UNDER PAVEMENT AND FOOTPATHS WHERE CONSTRUCTED ABOVE NATURAL SURFACE. REFER GEOTECH REPORT FOR SPECIFICATION

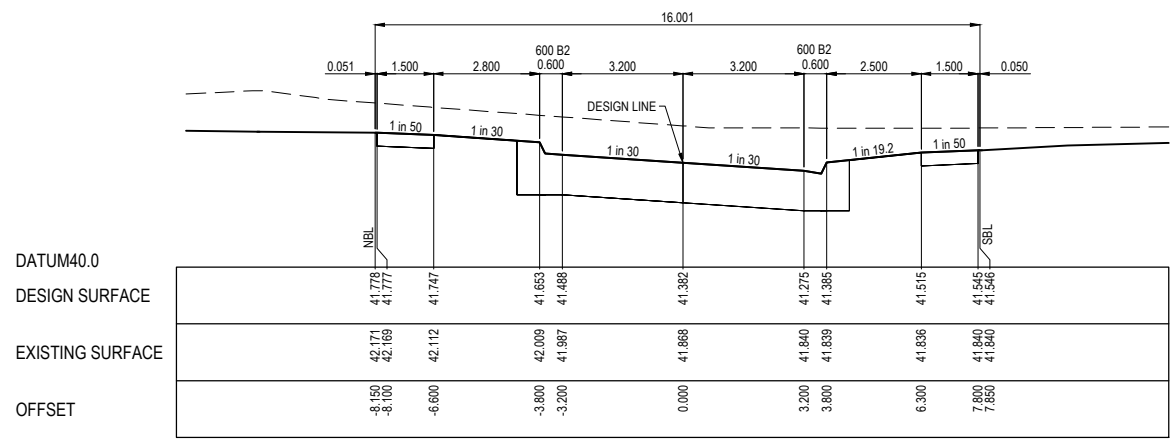

RTPCH 410.903

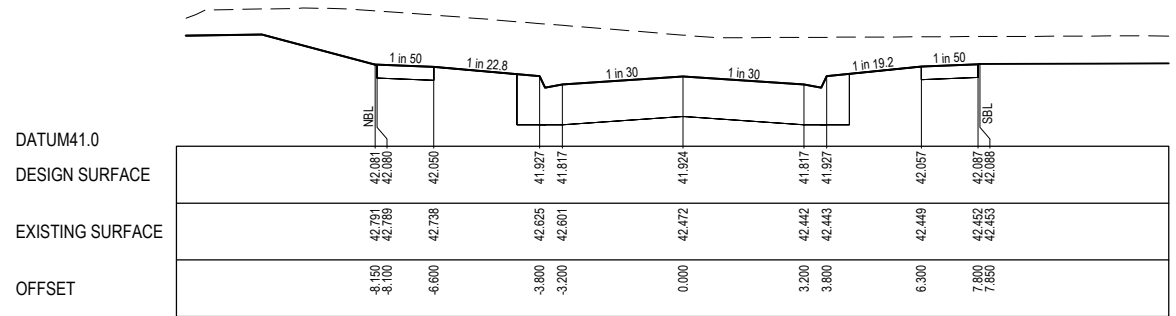

RTPCH 388.499

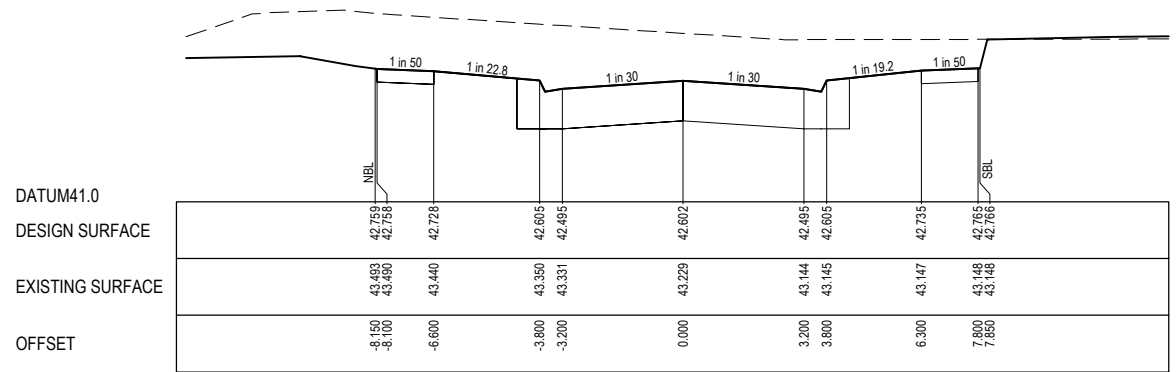

RTPCH 363.846

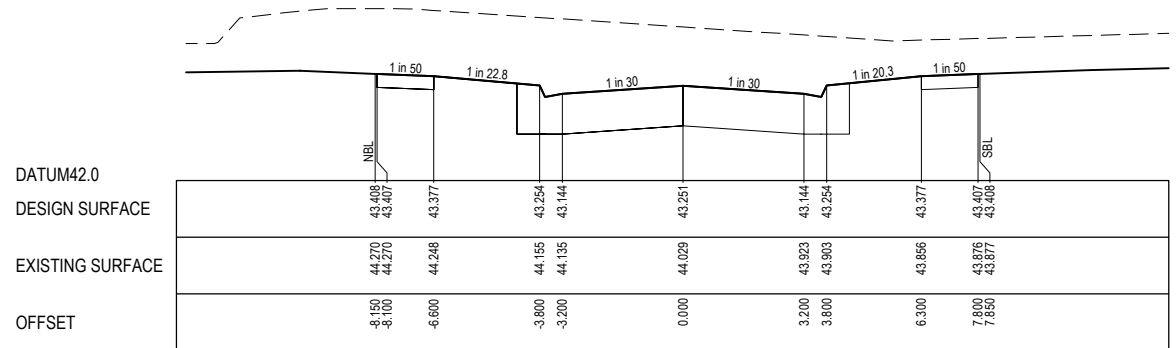

RTPCH 340.243

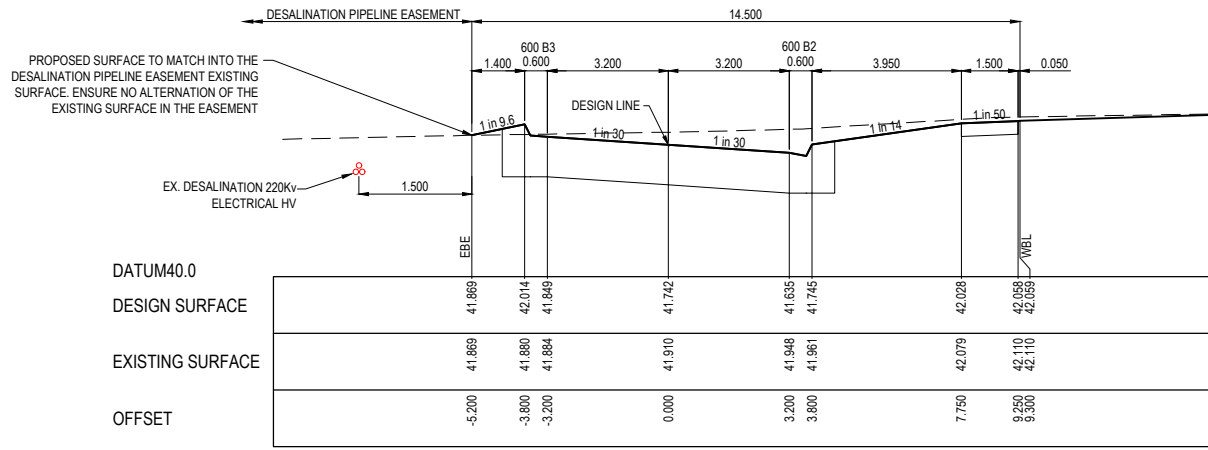

CH 514.474

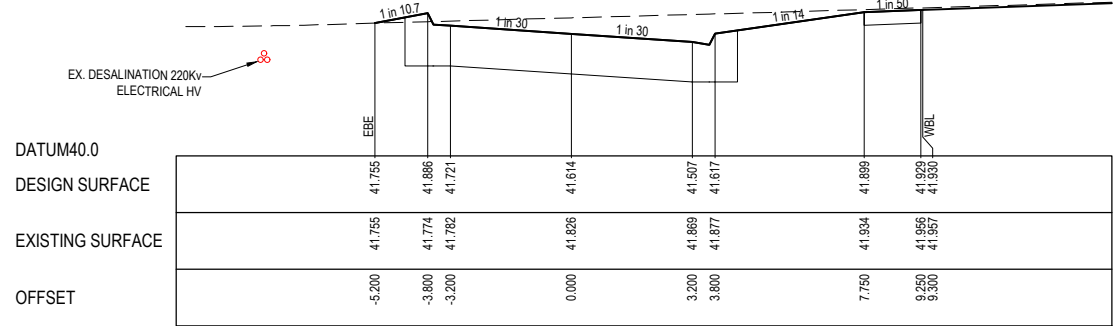

CH 501.974

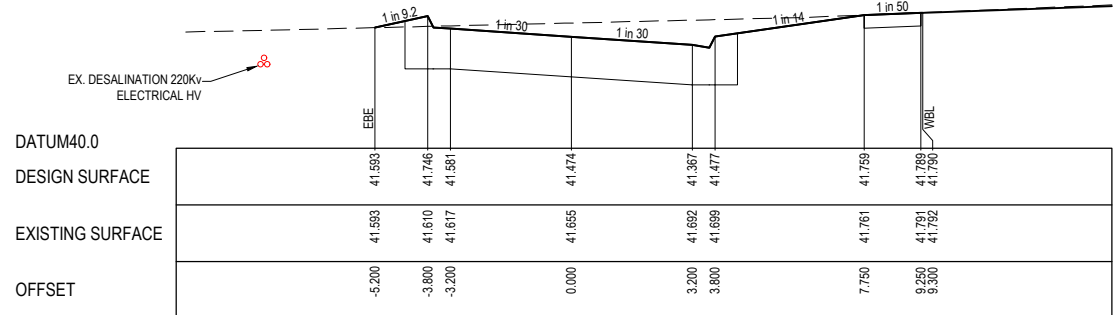

CH 473.974

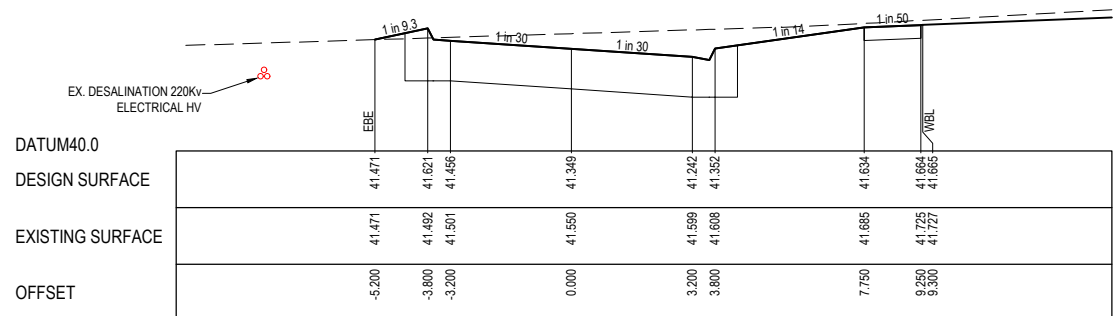

CH 448.974

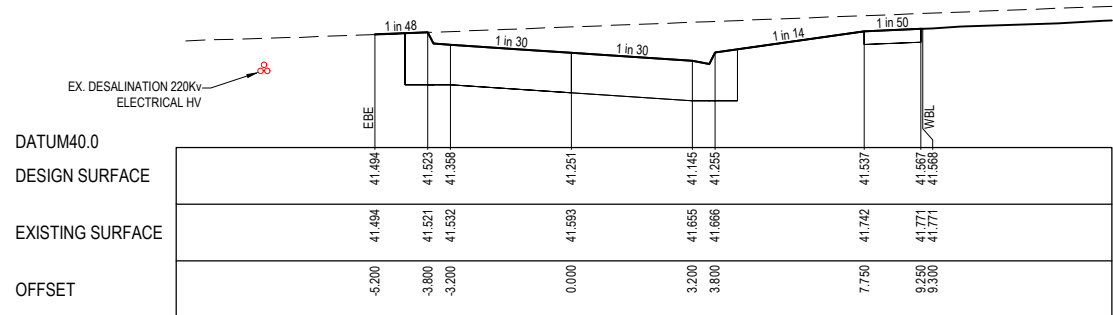

RTPCH 429.480

ISSUED FOR CONSTRUCTION

© COPYRIGHT All rights reserved Beveridge Williams & Co. Pty Ltd has granted a licence to the principle to use this document for its intended purpose. No unauthorised copying is permitted									
REV	DESCRIPTION	DATE	DRN.	APP.	REV	DESCRIPTION	DATE	DRN.	APP.
A	ISSUED FOR CONSTRUCTION	06.06.22	N.T.	M.F.					

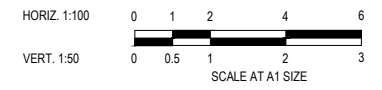

Designed: N. IVETIC, 28.04.2022
 Drawn: N. TABUENA
 Approved: M. FELICIANO, 29.04.2022
 PS Number: PS902134A

1 Glenferrie Road
 Malvern VIC 3144
 ph: 03 9524 8888
 www.beveridgewilliams.com.au

Project Details: MERIDIAN CENTRAL ESTATE
 STAGE 35
 CITY OF CASEY

Drawing Title: ROAD CROSS SECTIONS
 CARORA CIRCUIT
 (SHEET 2 OF 2)

Sheet 11 of 17
 Scale: 1:100 H 1:50 V @ A1
 Project Ref: 1801767, Stage No: 35, Drawing No: 203, Rev: A

K:\Ubs Data\1801767 - Meridian_Eng\Stage 35\Drawings\1801767-35-200-RXS.dwg

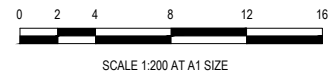
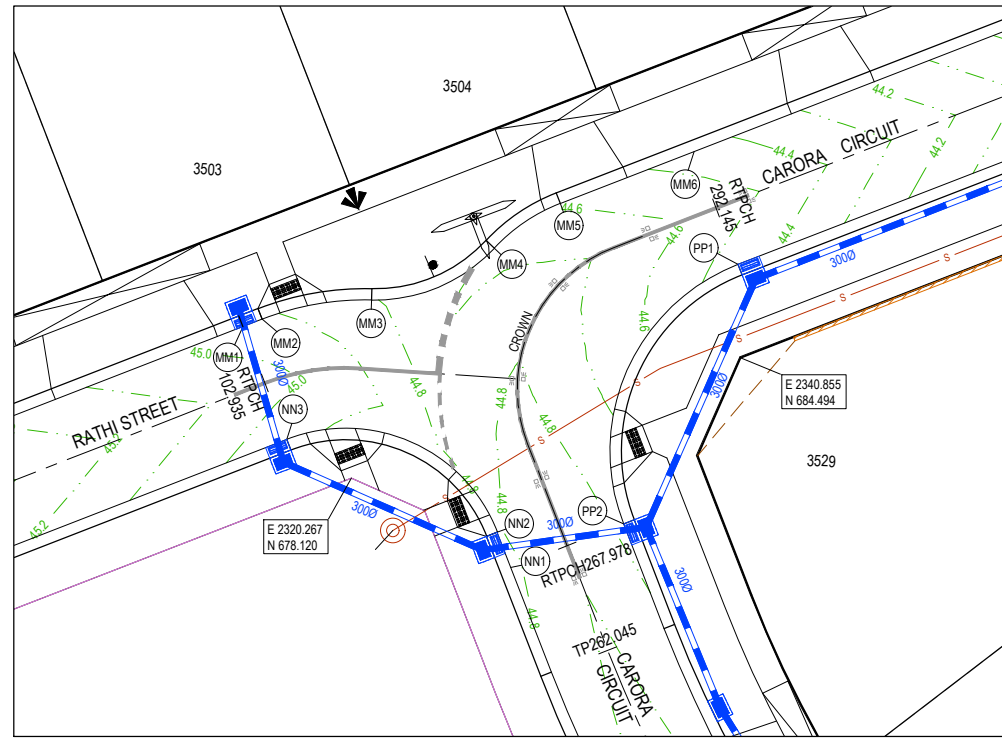

LEGEND

- STORMWATER DRAIN, PIT & PROPERTY INLET
- MELBOURNE WATER DRAIN & PIT
- SWALE DRAIN
- SEWER & MAINTENANCE STRUCTURES
- HOUSE DRAIN
- TACTILE PAVERS (INDICATIVE ONLY)
- EXISTING HOUSE DRAIN
- RETAINING WALL
- PAVEMENT TREATMENT
- CONCRETE EDGE STRIP WITH SUBSOIL DRAIN, "NO ROAD" SIGN & BARRIER
- LIMIT OF WORKS
- EXISTING TREE TO BE REMOVED
- PERMANENT SURVEY MARK
- TEMPORARY BENCH MARK
- PROPOSED DRIVEWAY

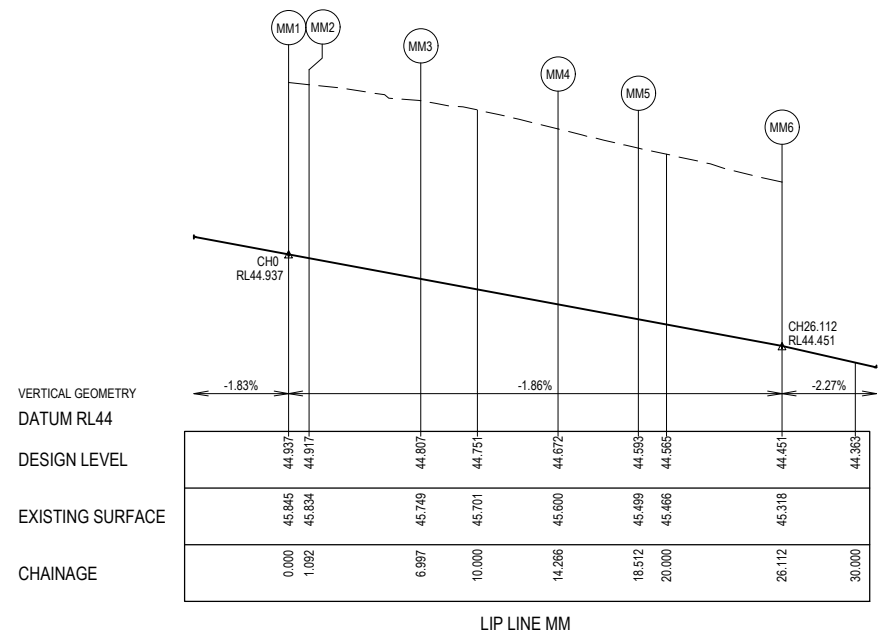
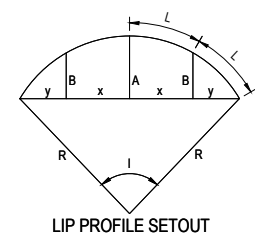

ALIGNMENT MM

Point no	Easting	Northing	RL
MM1	2314.530	686.138	44.937
MM2	2315.549	686.533	44.917
MM3	2321.327	687.543	44.807
MM4	2327.828	690.284	44.672
MM5	2331.313	692.646	44.593
MM6	2338.399	695.393	44.451

Curve no	I	Radius	Arc	A	B	X	Y	L	Mid point RL
MM2 - MM3	22.554	15.000	5.905	0.290	0.217	1.474	1.459	1.476	44.862
MM3 - MM4	48.431	8.600	7.269	0.757	0.565	1.804	1.724	1.817	44.739
MM4 - MM5	25.878	9.400	4.246	0.239	0.179	1.059	1.046	1.061	44.632

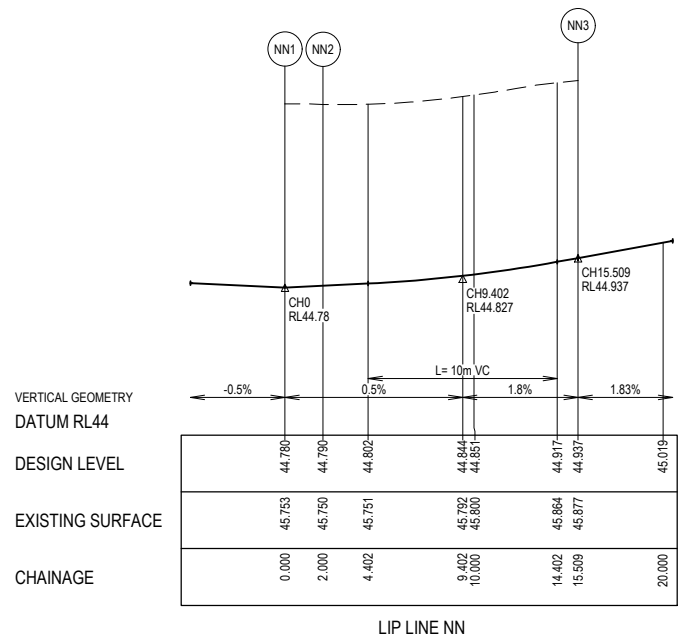

ALIGNMENT NN

Point no	Easting	Northing	RL
NN1	2328.694	673.397	44.780
NN2	2327.971	675.262	44.790
NN3	2316.844	680.171	44.937

Curve no	I	Radius	Arc	A	B	X	Y	L	Mid point RL
NN2 - NN3	90.000	8.600	13.509	2.519	1.864	3.291	2.790	3.377	44.836

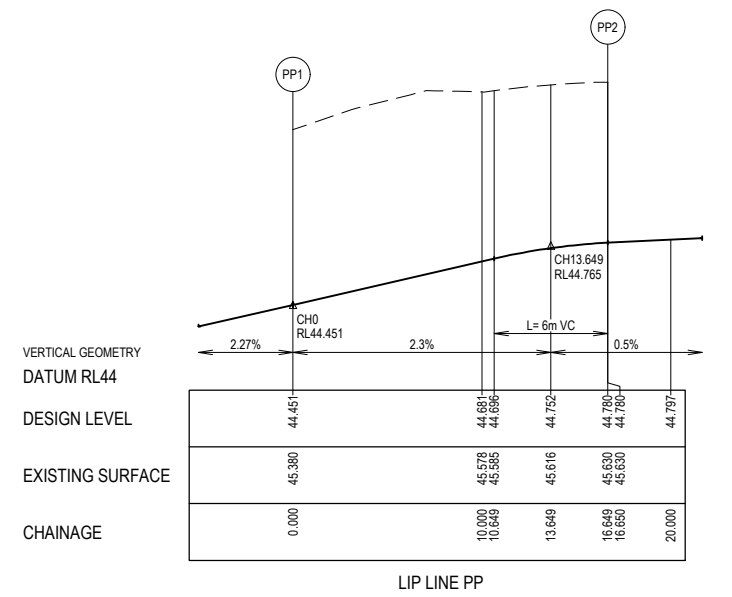

ALIGNMENT PP

Point no	Easting	Northing	RL
PP1	2340.713	689.426	44.451
PP2	2334.661	675.711	44.780

Curve no	I	Radius	Arc	A	B	X	Y	L	Mid point RL
PP1 - PP2	90.000	10.600	16.650	3.105	2.298	4.056	3.439	4.163	44.643

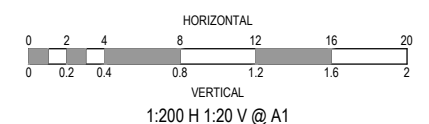

ISSUED FOR CONSTRUCTION

© COPYRIGHT All rights reserved
Beveridge Williams & Co. Pty Ltd has granted a licence to the principle to use this document for its intended purpose.
No unauthorised copying is permitted

REV	DESCRIPTION	DATE	DRN.	APP.	REV	DESCRIPTION	DATE	DRN.	APP.
A	ISSUED FOR CONSTRUCTION	06.06.22	N.T.	M.F.					

		Designed Date N. IVETIC 28.04.2022		Project Details MERIDIAN CENTRAL ESTATE STAGE 35 CITY OF CASEY	Sheet 12 of 17
		Drawn N. TABUENA		Drawing Title INTERSECTION DETAILS (SHEET 1 OF 2)	Scale 1:200 @ A1
		Approved Date M. FELICIANO 29.04.2022	1 Glenferrie Road Malvern VIC 3144 ph: 03 9524 8888 www.beveridgewilliams.com.au	Project Ref 1801767	Stage No 35
		PS Number PS902134A		Drawing No 300	Rev A

K:\Jobs Data\1801767 - Meridian_Eng\Stage 35\Drawings\1801767-35-300-INT.dwg

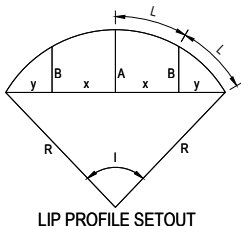
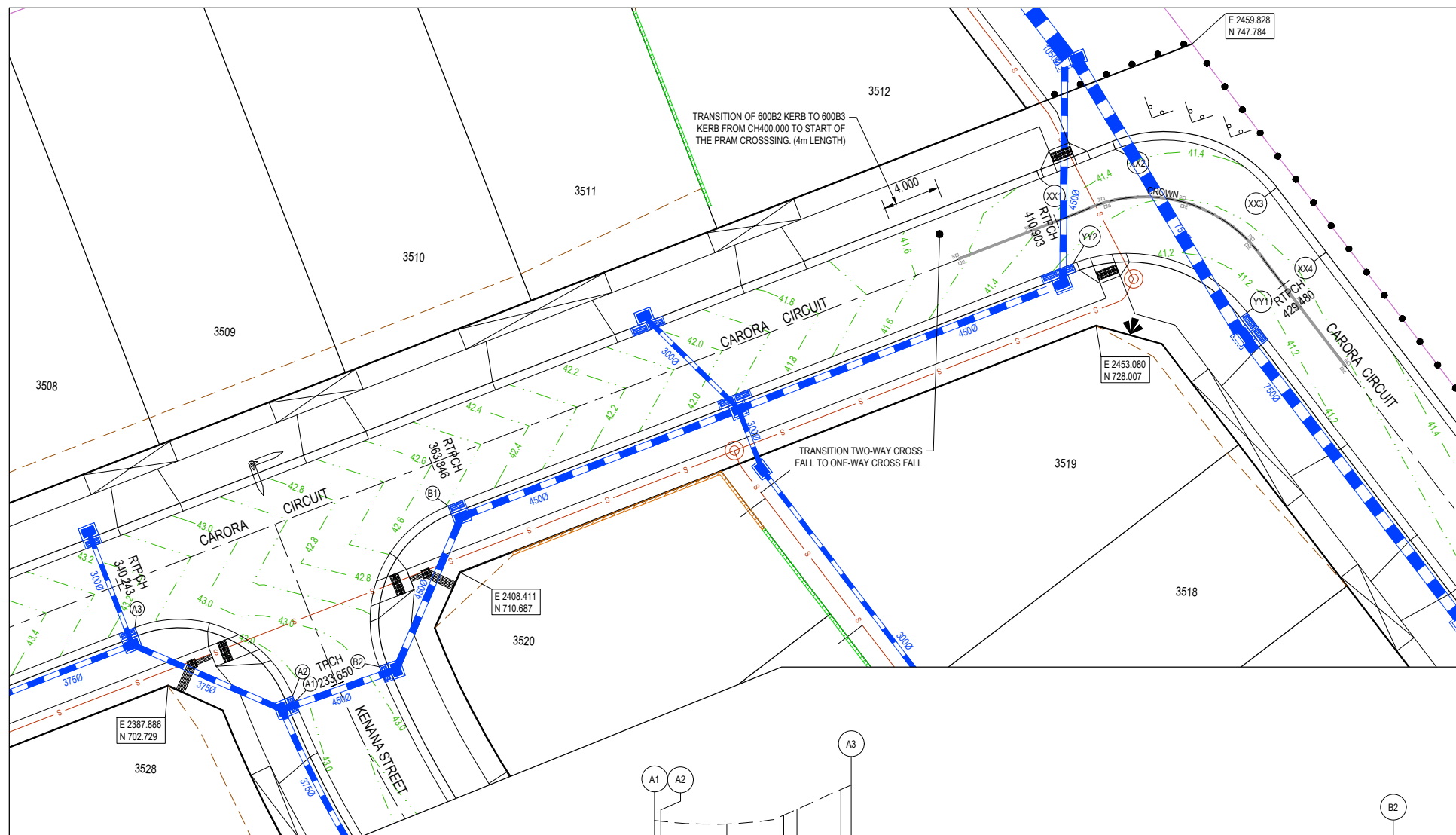

LIP PROFILE SETOUT

LEGEND

- STORMWATER DRAIN, PIT & PROPERTY INLET
- MELBOURNE WATER DRAIN & PIT
- SWALE DRAIN
- SEWER & MAINTENANCE STRUCTURES
- HOUSE DRAIN
- TACTILE PAVERS (INDICATIVE ONLY)
- EXISTING HOUSE DRAIN
- RETAINING WALL
- PAVEMENT TREATMENT
- CONCRETE EDGE STRIP WITH SUBSOIL DRAIN, 'NO ROAD' SIGN & BARRIER
- LIMIT OF WORKS
- EXISTING TREE TO BE REMOVED
- PERMANENT SURVEY MARK
- TEMPORARY BENCH MARK
- PROPOSED DRIVEWAY

VERTICAL GEOMETRY
DATUM RL42

DESIGN LEVEL

EXISTING SURFACE

CHAINAGE

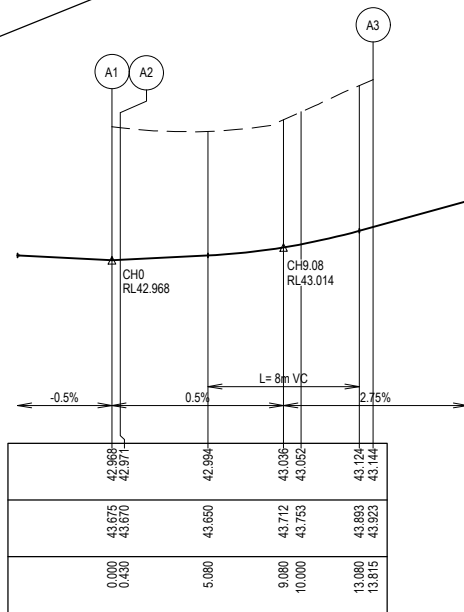

LIP LINE A

ALIGNMENT A

Point no	Easting	Northing	RL
A1	2396.802	701.621	42.968
A2	2396.640	702.019	42.971
A3	2385.558	706.814	43.144

Curve no	I	Radius	Arc	A	B	X	Y	L	Mid point RL
A1 - A2	0.347	71.050	0.430	0.000	0.107	0.107	0.107	0.107	42.970
A2 - A3	89.177	8.600	13.385	2.475	1.832	3.263	2.775	3.346	43.010

VERTICAL GEOMETRY
DATUM RL42

DESIGN LEVEL

EXISTING SURFACE

CHAINAGE

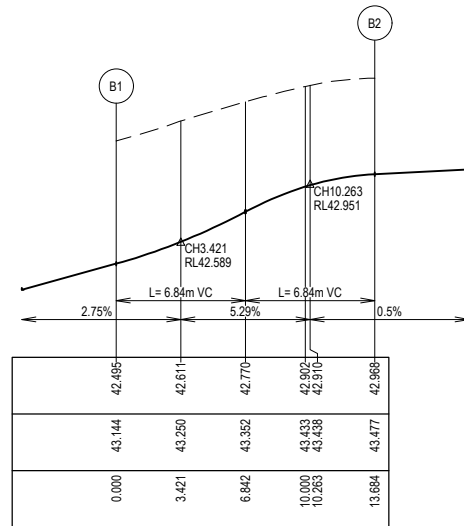

LIP LINE B

ALIGNMENT B

Point no	Easting	Northing	RL
B1	2407.565	715.346	42.495
B2	2402.721	704.056	42.968

Curve no	I	Radius	Arc	A	B	X	Y	L	Mid point RL
B1 - B2	91.170	8.600	13.684	2.581	1.910	3.332	2.811	3.421	42.770

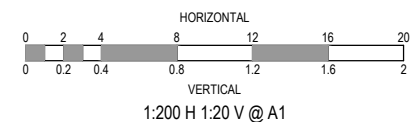

VERTICAL GEOMETRY
DATUM RL40

DESIGN LEVEL

EXISTING SURFACE

CHAINAGE

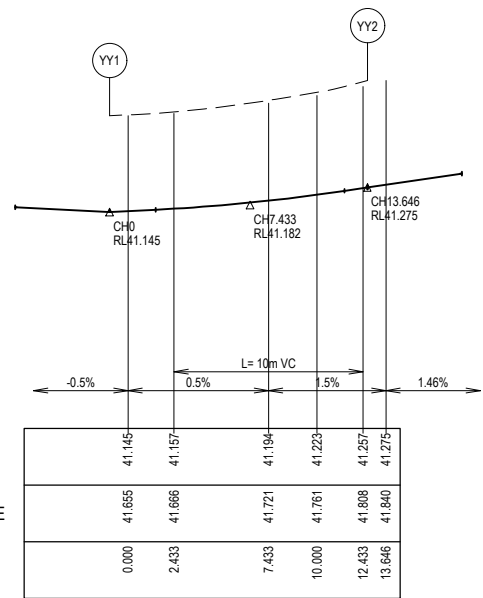

LIP LINE YY

ALIGNMENT YY

Point no	Easting	Northing	RL
YY1	2463.688	728.918	41.145
YY2	2451.439	732.358	41.275

Curve no	I	Radius	Arc	A	B	X	Y	L	Mid point RL
YY1 - YY2	73.759	10.600	13.646	2.121	1.577	3.353	3.009	3.411	41.188

VERTICAL GEOMETRY
DATUM RL41

DESIGN LEVEL

EXISTING SURFACE

CHAINAGE

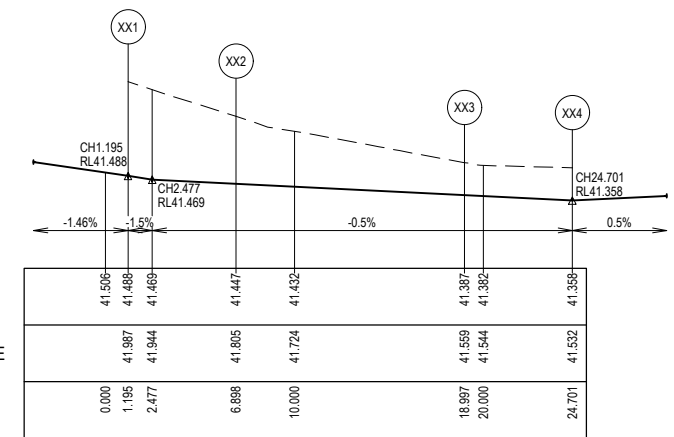

LIP LINE XX

ALIGNMENT XX

Point no	Easting	Northing	RL
XX1	2449.125	738.325	41.488
XX2	2454.443	740.387	41.447
XX3	2465.304	737.338	41.387
XX4	2468.772	732.810	41.358

Curve no	I	Radius	Arc	A	B	X	Y	L	Mid point RL
XX2 - XX3	73.745	9.400	12.099	1.880	1.398	2.973	2.668	3.025	41.417

ISSUED FOR CONSTRUCTION

© COPYRIGHT All rights reserved
Beveridge Williams & Co. Pty Ltd has granted a licence to the principle to use this document for its intended purpose.
No unauthorised copying is permitted

REV	DESCRIPTION	DATE	DRN.	APP.	REV	DESCRIPTION	DATE	DRN.	APP.
A	ISSUED FOR CONSTRUCTION	06.06.22	N.T.	M.F.					



Designed
Date
28.04.2022

Drawn
N. TABUENA

Approved
Date
29.04.2022

M. FELICIANO

PS Number
PSS02134A



Project
Details
MERIDIAN CENTRAL ESTATE
STAGE 35
CITY OF CASEY

Drawing
Title
INTERSECTION DETAILS
(SHEET 2 OF 2)

Sheet 13 of 17

Scale
1:200 @ A1

Project Ref	Stage No	Drawing No	Rev
1801767	35	301	A

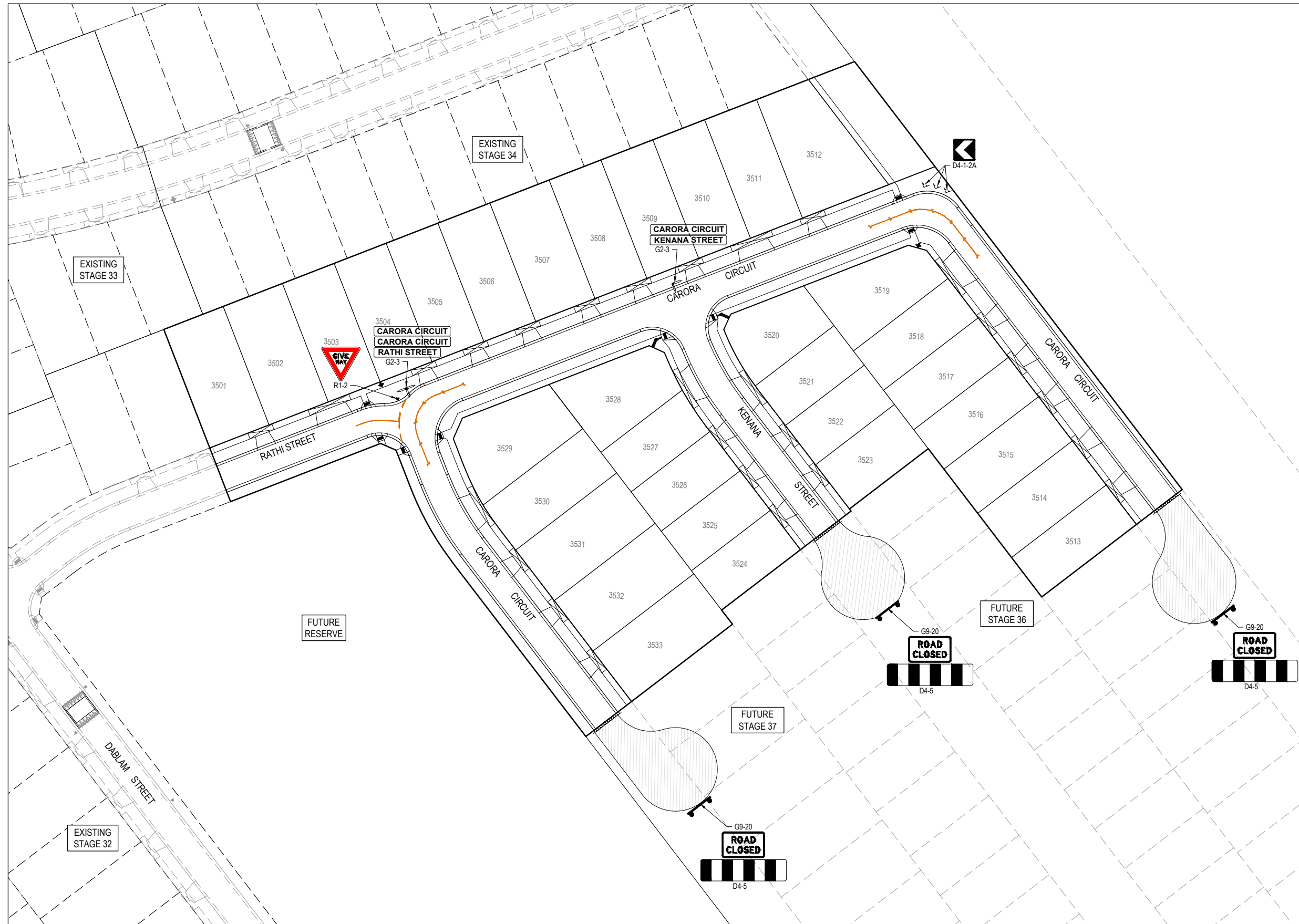

- NOTES**
- RRPM'S AT MAX 6m SPACING.
 - LINEMARKING TO BE EXTENDED AT LEAST 6m FROM THE TANGENT POINT
 - LINEMARKING IN ACCORDANCE WITH AS1742.
 - TGSI TO BE INSTALLED IN ACCORDANCE WITH VICROADS RDN 06-06 - JULY 2010
 - ALL STREET NAME SIGNS AT INTERSECTIONS TO INCLUDE RELEVANT STREET NUMBERING.
 - ALL LINE MARKING PAINT SHALL BE LONG LIFE TYPE. LATERAL WORKS AND ARROWS BEING COLD APPLIED PLASTIC TROWELLED INTO PLACE (MATERIAL DEGADUR PASTELINE) AND LONGITUDINAL LINES BEING EXTRUDED THERMOPLASTIC MATERIAL.

ISSUED FOR CONSTRUCTION

REV	DESCRIPTION	DATE	DRN	APP	REV	DESCRIPTION	DATE	DRN	APP
A	ISSUED FOR CONSTRUCTION	06.06.22	N.T.	M.F.					

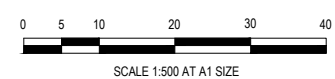

Designed Date: N. IVETIC 28.04.2022
 Drawn: N. TABUENA
 Approved Date: M. FELICIANO 29.04.2022
 PS Number: PSS02134A

BW Beveridge Williams
 1 Glenferrie Road
 Malvern VIC 3144
 ph: 03 9524 8888
 www.beveridgewilliams.com.au

Project Details: MERIDIAN CENTRAL ESTATE
 STAGE 35
 CITY OF CASEY
 Drawing Title: SIGNAGE & LINE MARKING PLANS

Sheet 14 of 17
 Scale: 1:500 @ A1
 Project Ref: 1801767
 Stage No: 35
 Drawing No: 350
 Rev: A



NOTES:
 ALL STORMWATER DRAINS UP TO AND INCLUDING 750mm DIA. ARE TO BE CLASS 2 R.R.J. PIPES UNLESS NOTED OTHERWISE.

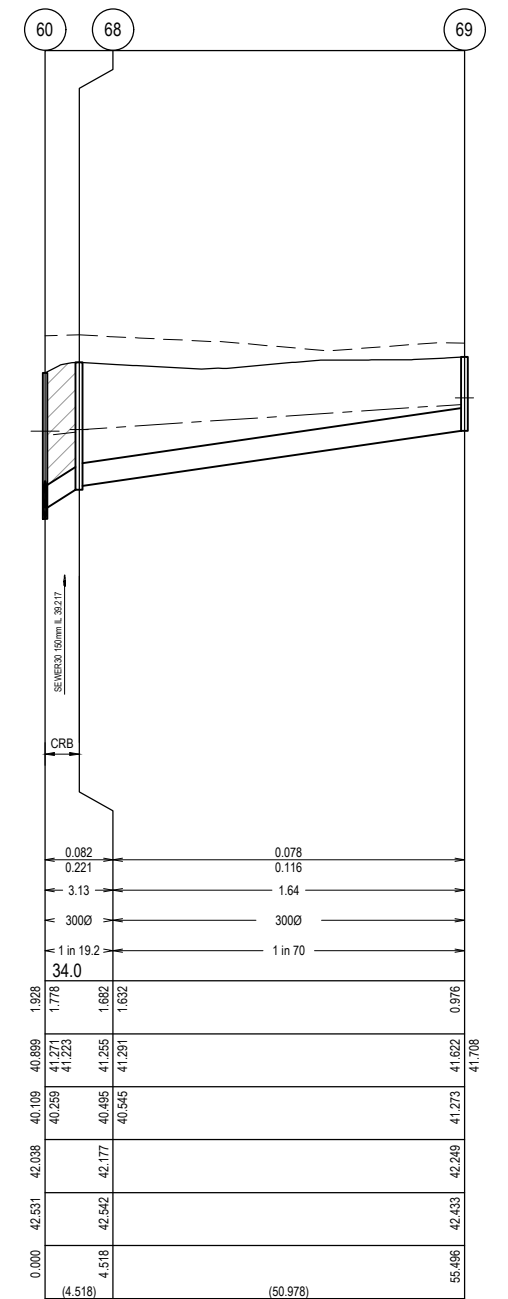
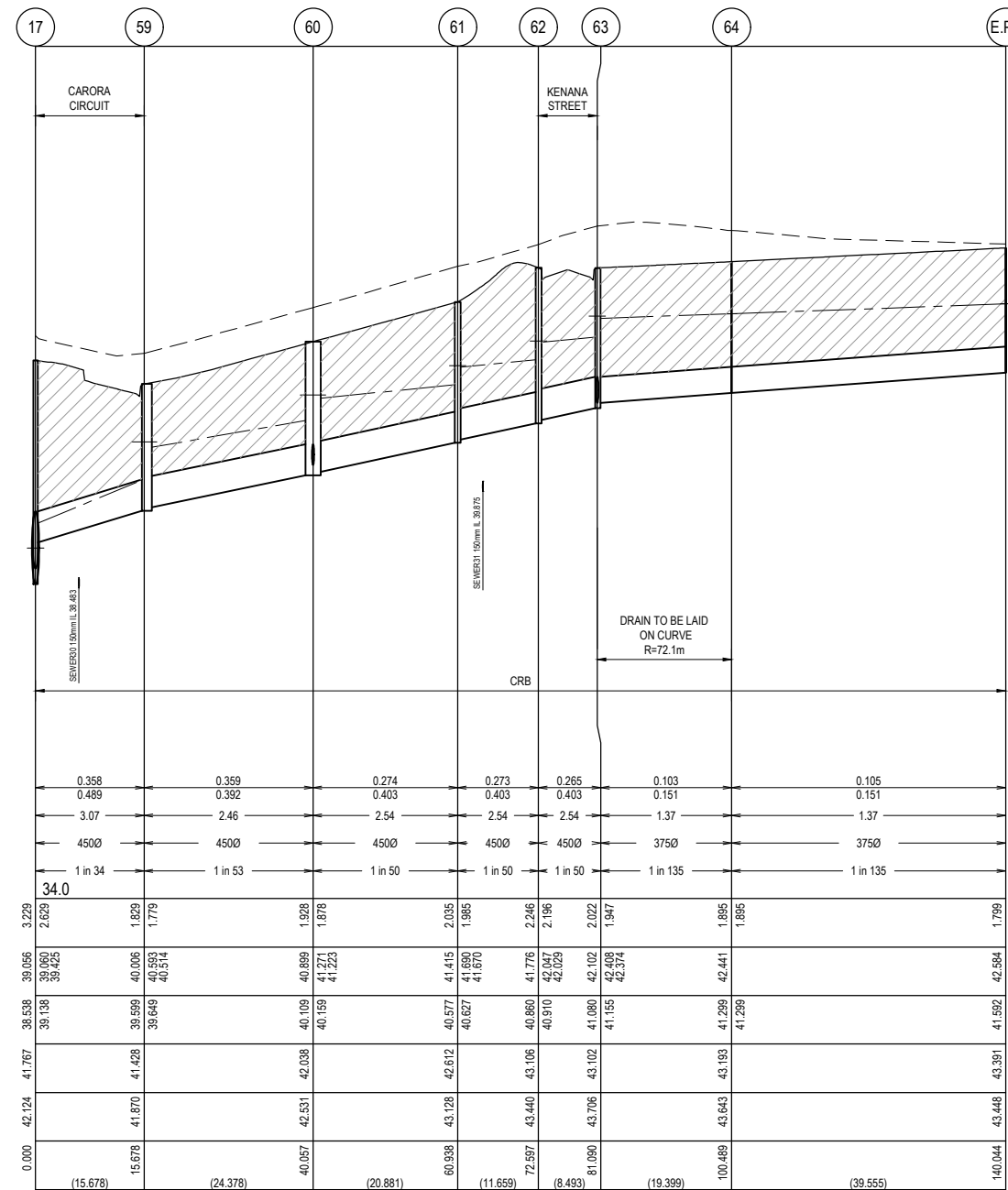
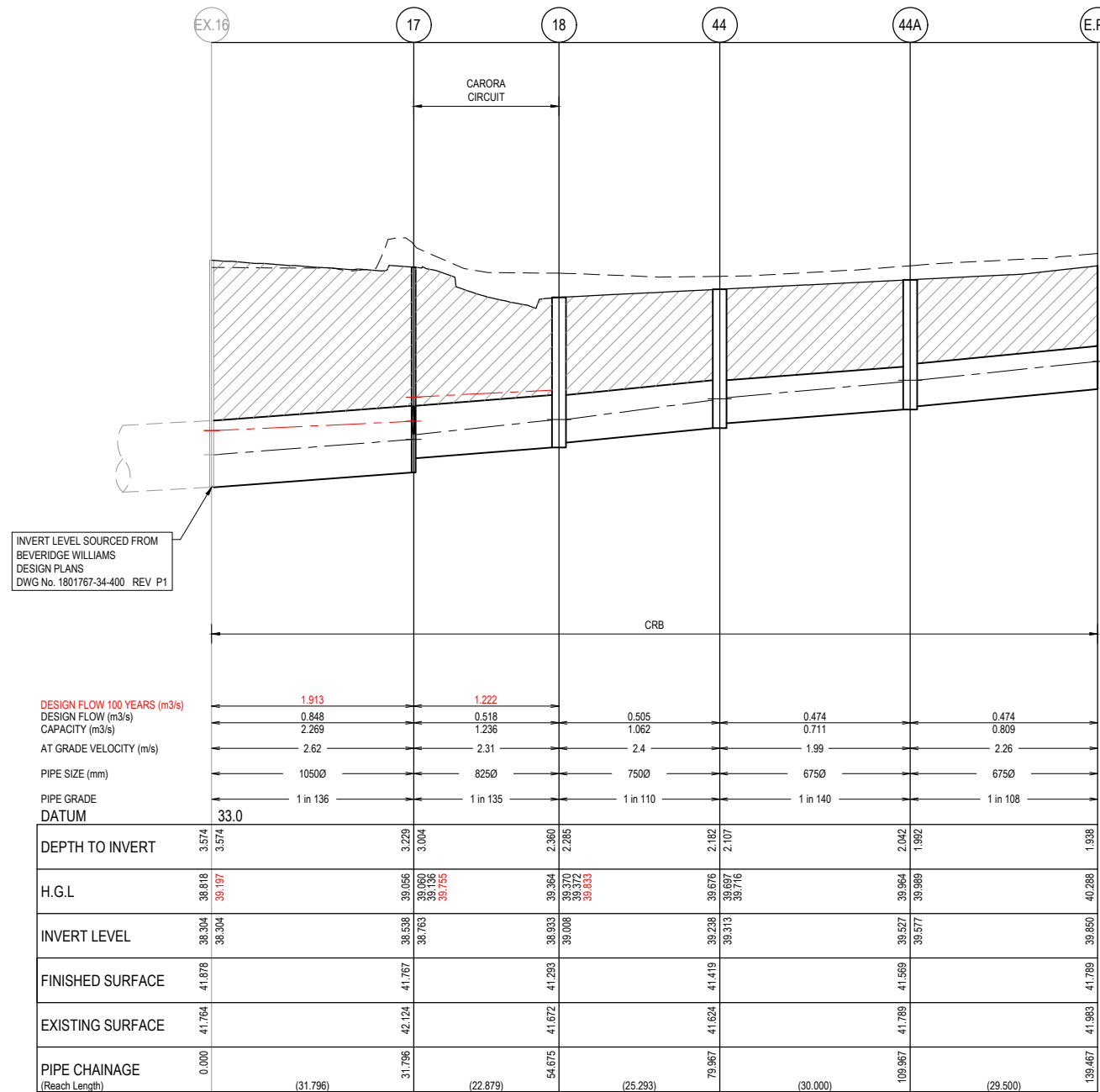
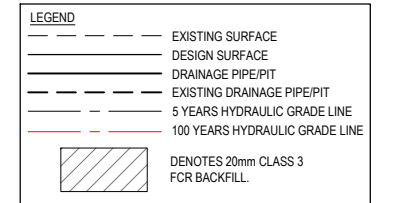

INVERT LEVEL SOURCED FROM BEVERIDGE WILLIAMS DESIGN PLANS DWG No. 1801767-34-400 REV P1

DESIGN FLOW 100 YEARS (m³/s)
 DESIGN FLOW (m³/s)
 CAPACITY (m³/s)
 AT GRADE VELOCITY (m/s)
 PIPE SIZE (mm)
 PIPE GRADE DATUM

ISSUED FOR CONSTRUCTION

REV	DESCRIPTION	DATE	DRN.	APP.	REV	DESCRIPTION	DATE	DRN.	APP.
A	ISSUED FOR CONSTRUCTION	06.06.22	N.T.	M.F.					

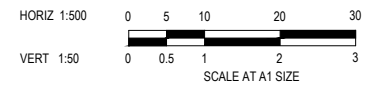

Designed Date: N. IVETIC 28.04.2022
 Drawn: N. TABUENA
 Approved Date: M. FELICIANO 29.04.2022
 PS Number: PSS02134A



Project Details: MERIDIAN CENTRAL ESTATE STAGE 35 CITY OF CASEY
 Drawing Title: DRAINAGE LONGITUDINAL SECTIONS (SHEET 1 OF 2)

Sheet 15 of 17
 Scale: 1:500 H 1:50 V @ A1
 Project Ref: 1801767 Stage No: 35 Drawing No: 400 Rev: A

NOTES:
 ALL STORMWATER DRAINS UP TO AND INCLUDING 750mm DIA. ARE TO BE CLASS 2 R.R.J. PIPES UNLESS NOTED OTHERWISE.

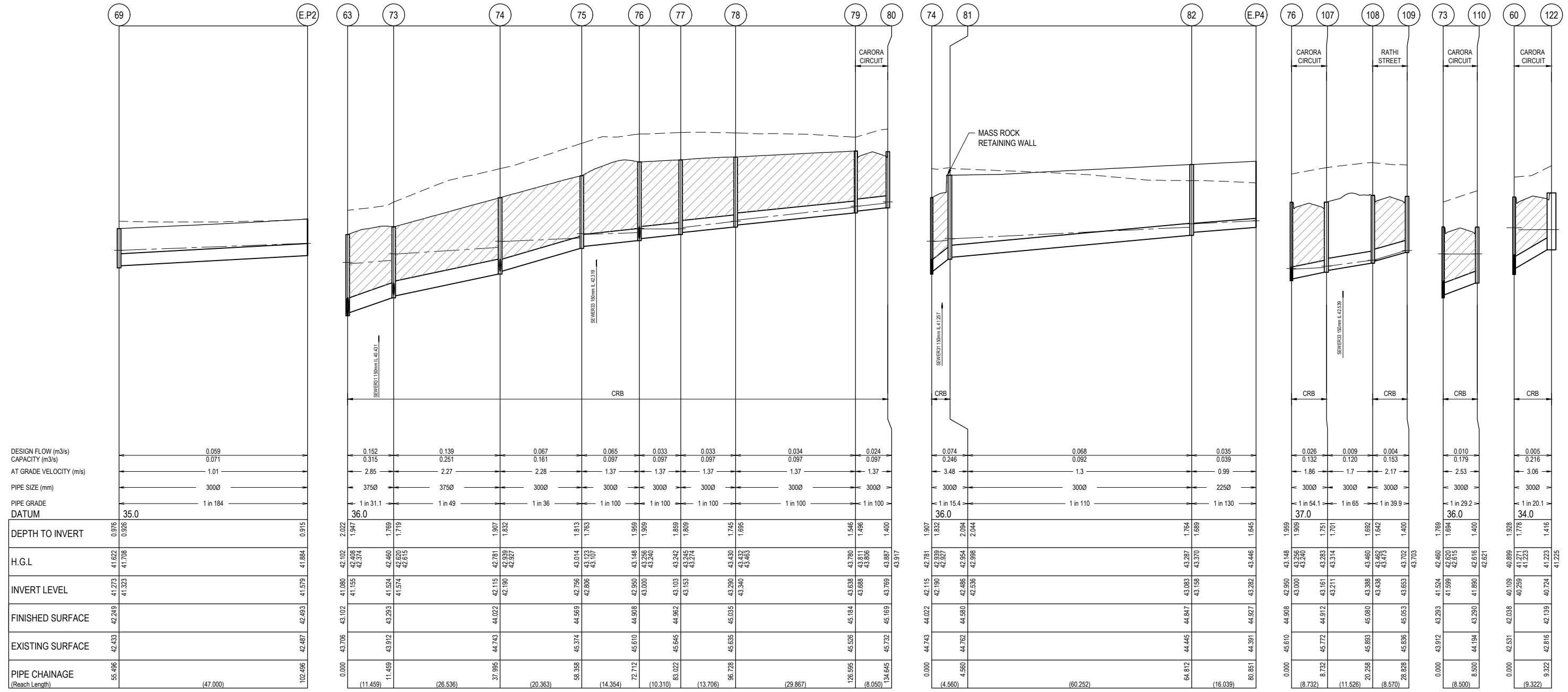
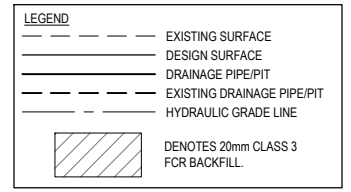

ISSUED FOR CONSTRUCTION

© COPYRIGHT All rights reserved
 Beveridge Williams & Co. Pty Ltd has granted a licence to the principle to use this document for its intended purpose.
 No unauthorised copying is permitted.

REV	DESCRIPTION	DATE	DRN.	APP.	REV	DESCRIPTION	DATE	DRN.	APP.
A	ISSUED FOR CONSTRUCTION	06.06.22	N.T.	M.F.					

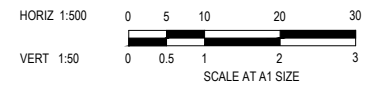

Designed Date: N. IVETIC 28.04.2022
 Drawn: N. TABUENA
 Approved Date: M. FELICIANO 29.04.2022
 PS Number: PSS02134A



Project Details: MERIDIAN CENTRAL ESTATE
 STAGE 35
 CITY OF CASEY
 Drawing Title: DRAINAGE LONGITUDINAL SECTIONS (SHEET 2 OF 2)

Sheet 16 of 17
 Scale: 1:500 H 1:50 V @ A1
 Project Ref: 1801767
 Stage No: 35
 Drawing No: 401
 Rev: A

K:\Jobs Data\1801767 - Meridian_Eng\Stage 35\Drawings\1801767-35-400-DLS.dwg

PIT SCHEDULE											
PIT NUMBER	TYPE	INTERNAL		INLET		OUTLET		F.S.L	DEPTH (m)	STANDARD DRAWING	REMARKS
		WIDTH (mm)	LENGTH (mm)	DIAMETER (mm)	INV R.L. (mm)	DIAMETER (mm)	INV R.L. (mm)				
Ex.16	EXISTING PIT			1050	38.304			41.878	3.574		CONNECT DRAIN INTO EXISTING PIT
17	JUNCTION PIT	1950	900	825	38.763	1050	38.538	41.767	3.229	EDCM 605 & 607	HAUNCH PIT TO 600 x 900 COVER
				450	39.138						
18	DOUBLE GRATED ENTRY PIT	1050	900	750	39.008	825	38.933	41.293	2.360	EDCM 602 & 607	HAUNCH PIT TO 600 x 900 COVER. INSTALL HEAVY DUTY CLASS D LID
44	DOUBLE GRATED ENTRY PIT	1050	900	675	39.313	750	39.238	41.419	2.182	EDCM 602 & 607	HAUNCH PIT TO 600 x 900 COVER
44A	DOUBLE GRATED ENTRY PIT	900	900	675	39.577	675	39.527	41.569	2.042	EDCM 602 & 607	HAUNCH PIT TO 600 x 900 COVER
E.P1	END PIPE					675	39.85	41.789	1.938		CAP PIPE FOR FUTURE CONNECTION
59	DOUBLE GRATED ENTRY PIT	750	900	450	39.649	450	39.599	41.428	1.829	EDCM 602 & 607	HAUNCH PIT TO 600 x 900 COVER
60	DOUBLE GRATED ENTRY PIT	750	900	450	40.159	450	40.109	42.038	1.928	EDCM 602 & 607	HAUNCH PIT TO 600 x 900 COVER
				300	40.259						
				300	40.259						
61	GRATED ENTRY PIT	750	900	450	40.627	450	40.577	42.612	2.035	EDCM 601 & 607	HAUNCH PIT TO 600 x 900 COVER
62	GRATED ENTRY PIT	600	900	450	40.910	450	40.860	43.106	2.246	EDCM 601	
63	GRATED ENTRY PIT	600	900	375	41.155	450	41.08	43.102	2.022	EDCM 601	
				375	41.155						
64	TANGENT POINT			375	41.299	375	41.299	43.193	1.895		
E.P3	END PIPE					375	41.592	43.391	1.799		CAP PIPE FOR FUTURE CONNECTION
68	JUNCTION PIT	600	900	300	40.545	300	40.495	42.177	1.682	EDCM 605	
69	JUNCTION PIT	600	900	300	41.323	300	41.273	42.249	0.976	EDCM 605	
E.P2	END PIPE					300	41.579	42.493	0.915		CAP PIPE FOR FUTURE CONNECTION
73	GRATED ENTRY PIT	600	900	375	41.574	375	41.524	43.293	1.769	EDCM 601	
				300	41.599						
74	JUNCTION PIT	600	900	300	42.190	375	42.115	44.022	1.907	EDCM 605	
				300	42.190						
75	GRATED ENTRY PIT	600	900	300	42.806	300	42.756	44.569	1.813	EDCM 601	
76	GRATED ENTRY PIT	600	900	300	43.000	300	42.950	44.908	1.959	EDCM 601	
				300	43.000						
77	JUNCTION PIT	600	900	300	43.153	300	43.103	44.962	1.859	EDCM 605	
78	JUNCTION PIT	600	900	300	43.340	300	43.290	45.035	1.745	EDCM 605	
79	GRATED ENTRY PIT	600	900	300	43.688	300	43.638	45.184	1.546	EDCM 601	
80	GRATED ENTRY PIT	600	900			300	43.769	45.169	1.400	EDCM 601	
81	JUNCTION PIT	600	900	300	42.536	300	42.486	44.58	2.094	EDCM 605	
82	JUNCTION PIT	600	900	225	43.158	300	43.083	44.847	1.764	EDCM 605	
E.P4	END PIPE					225	43.282	44.927	1.645		CAP PIPE FOR FUTURE CONNECTION
107	GRATED ENTRY PIT	600	900	300	43.211	300	43.161	44.912	1.751	EDCM 601	
108	GRATED ENTRY PIT	600	900	300	43.438	300	43.388	45.080	1.692	EDCM 601	
109	GRATED ENTRY PIT	600	900			300	43.653	45.053	1.400	EDCM 601	
110	GRATED ENTRY PIT	600	900			300	41.890	43.290	1.400	EDCM 601	
122	DOUBLE GRATED ENTRY PIT	600	900			300	40.724	42.139	1.416	EDCM 602	

ISSUED FOR CONSTRUCTION

© COPYRIGHT All rights reserved Beveridge Williams & Co. Pty Ltd has granted a licence to the principle to use this document for its intended purpose. No unauthorised copying is permitted											
REV	DESCRIPTION	DATE	DRN.	APP.	REV	DESCRIPTION	DATE	DRN.	APP.		
A	ISSUED FOR CONSTRUCTION	06.06.22	N.T.	M.F.							

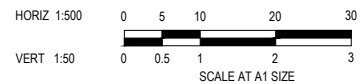

Designed Date: N. IVETIC 28.04.2022
Drawn: N. TABUENA
Approved Date: M. FELICIANO 29.04.2022
PS Number: PS902134A



Project Details: MERIDIAN CENTRAL ESTATE
STAGE 35
CITY OF CASEY
Drawing Title: PIT SCHEDULE

Sheet 17 of 17
Scale: 1:500 H 1:50 V @ A1
Project Ref: 1801767
Stage No: 35
Drawing No: 402
Rev: A